

NOTES:

1. RAW METAL PARTS SHALL BE PURCHASED EXTERIOR POLISHED AND BUFFED. FOR MATERIAL SPECIFICATIONS SEE PS-E.001. FOR FINISH SPECIFICATIONS SEE SOP-Q.001 AND PS-Q.007.
2. PART GEOMETRY IS DEFINED BY CAD MODEL PROVIDED BY ENGINEERING.
3. AESTHETIC DIMENSION. FOLLOW AESTHETIC DIMENSIONS AND CAD MODEL TO MAINTAIN DESIGN INTENT (SEE PS-E.002 FOR "AESTHETIC DIMENSION" DEFINITION).
4. DIMENSIONS IN BRACKETS [] ARE IN MILLIMETERS AND FOR REFERENCE ONLY.
5. \longleftrightarrow INDICATES STROKE DIRECTION FOR SATIN FINISHES ONLY.
6. DO NOT POLISH THIS SURFACE.
7. PARTS WITH WETTED SURFACE AREA NOTED WITHIN THE ATTRIBUTES FIELD MUST MEET TOXICITY REQUIREMENTS (SEE PS-E.001 SECTION 4.0).

ATTRIBUTES	
TOTAL SURFACE AREA(in ²)	69.164
PLATED SURFACE AREA(in ²)	34.418
WETTED SURFACE AREA(in ²)	N/A
WEIGHT LB. [G]	.179 LB. [81 G.]
VOLUME(in ³)	.585

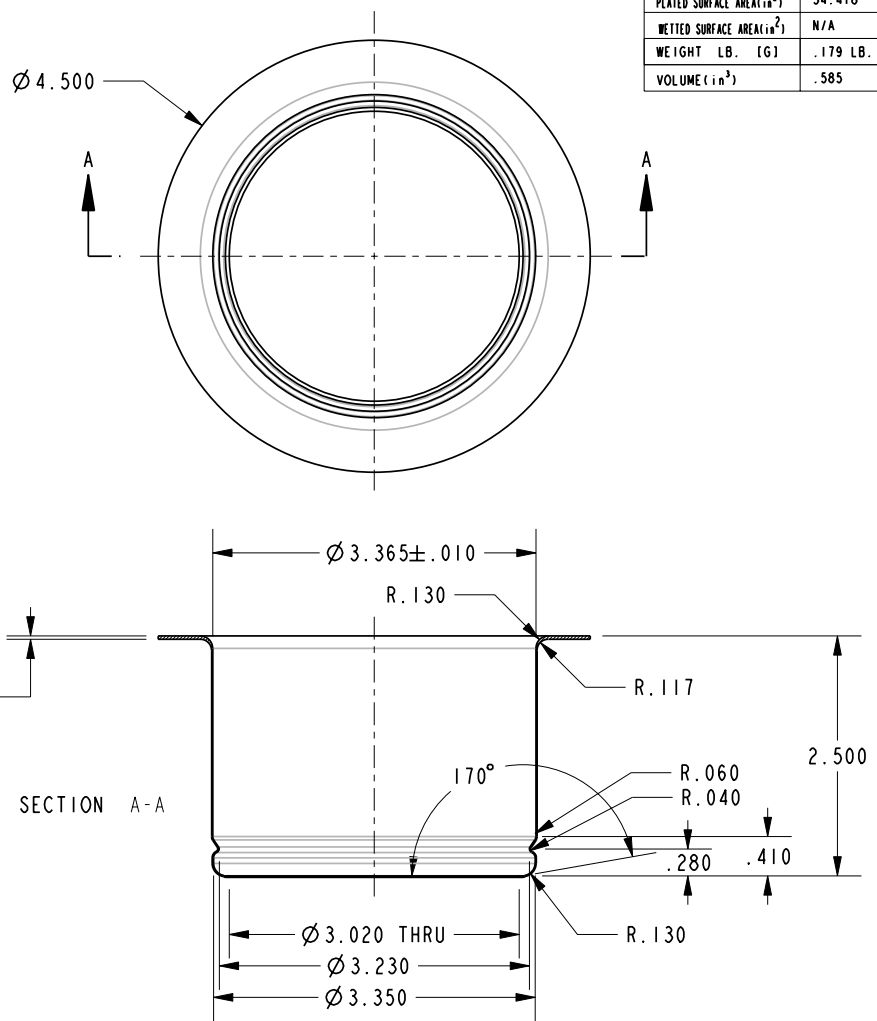
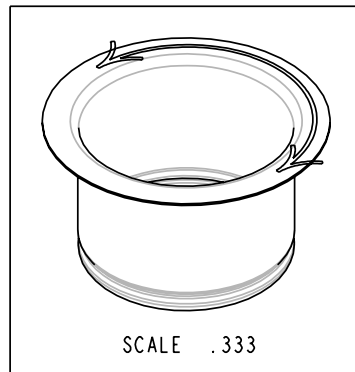

ZONE	REV	DESCRIPTION	DATE	APPROVED
-	B	EO-0860	09/06/07	V.V.
-	A	EO-0739	06/28/06	JW
-	-	EO-0699	05/18/06	JW

COPYRIGHT 2005 BRASSTECH, INC. THESE DRAWINGS AND THE DESIGNS DEPICTED HEREIN ARE THE PROPRIETARY PROPERTY OF BRASSTECH. ANY USE OR REPRODUCTION IS SUBJECT TO THE EXPRESS APPROVAL OF BRASSTECH. UNAUTHORIZED USE IS STRICTLY PROHIBITED. ALL RIGHTS RESERVED.

-	-	UNITS ARE: INCHES [MM]
-	-	TOLERANCES ARE:
NEXT ASSY	USED ON	FRACTIONS DECIMALS ANGLES ±1/64" .X ±.1 ±1° .XX ±.010 .XXX ±.005
APPLICATION		(X.XXX) DENOTES CRITICAL DIMS. ALL THREADS ARE CRITICAL
REMOVE ALL BURRS AND SHARP EDGES		DRAWN H.LE 05/18/06
MATERIAL BRASS - SEE NOTE 1		CHECKED J.MANGA 05/18/06
FINISH SEE NOTE 1		APPROVED J.MANGA 05/18/06

BRASSTECH 2001 E. CARNEGIE AVE. SANTA ANA, CA 92705 (949) 417-5207
INCORPORATED

DEEP DISPOSAL FLANGE

DWG NO. 112A REV B

SCALE .500 REF. - SHEET | OF |