

**RP100224**  
 15MM Cartridge Service Tool  
 Herramienta de servicio para el cartucho 15 MM  
 Clé de 15 MM pour cartouche

**RP100926▲**  
 Lift Rod, Finial & O-Ring  
 Barra de elevación, Finial y Juntas tórica  
 Tige de levage, embout et joint torique

**RP28653▲**  
 Metal Pop-Up Assembly Less Lift Rod  
 Ensamble de Metal del Desagüe Automático Sin la Barra de Alzar  
 Renvoi mécanique en métal sans la tige de manoeuvre

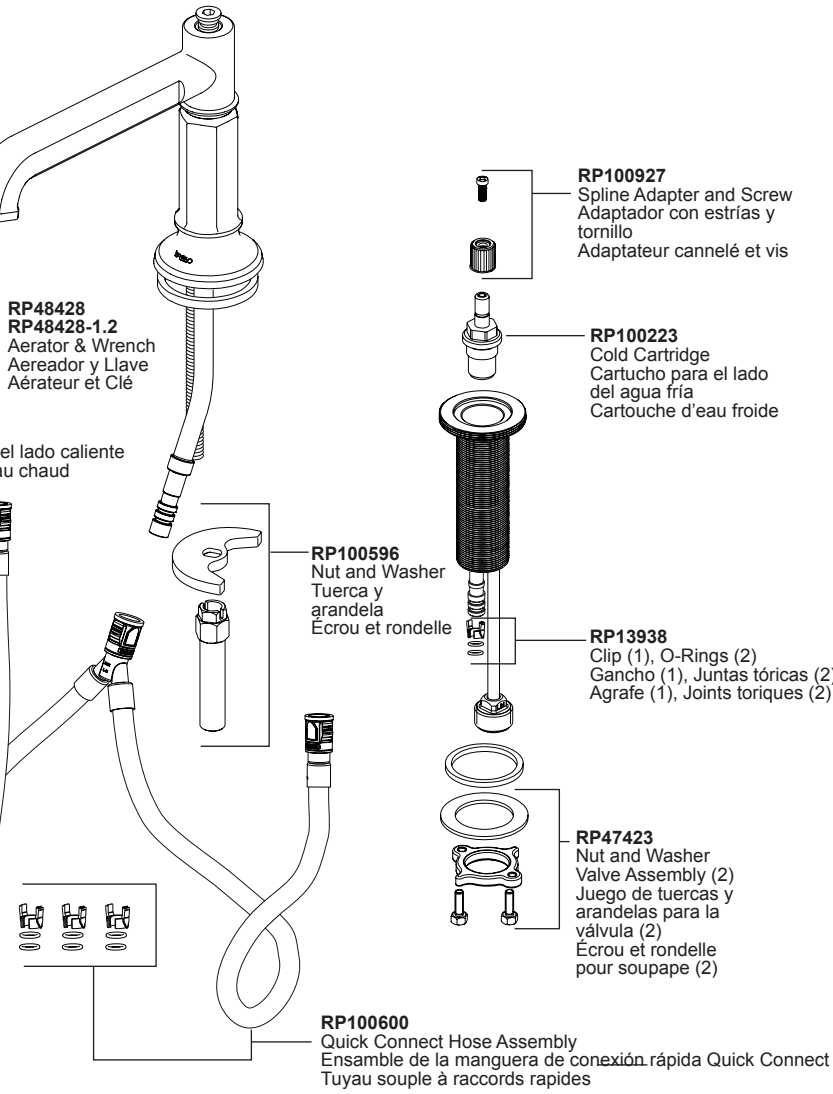
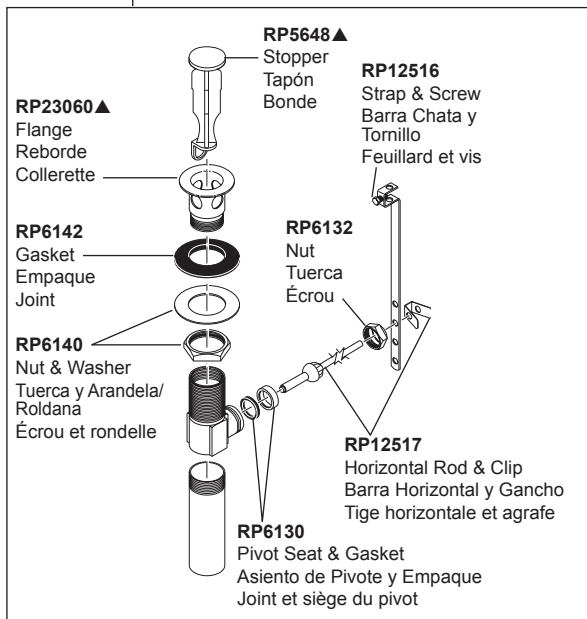
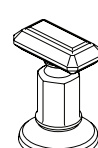
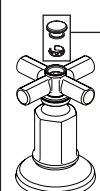
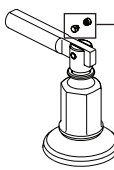
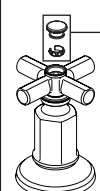
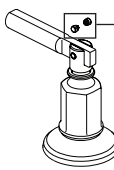

Handles (sold separately) Manijas (se vende por separado) Manettes (vendu séparément)	
<p><b>HK5376▲ (Knob Handle/Mango Perilla/Poignée de Manette)</b>                      Handles &amp; O-Rings                      Manijas y Anillo "O"                      Manettes et Joint torique</p> 	<p><b>HX5376▲ (Cross Handle/Mango Cruzado/Traverser la Manche)</b>                      Handles &amp; O-Rings                      Manijas y Anillo "O"                      Manettes et Joint torique</p> 
<p><b>HL5376▲ (Lever/Palanca/Manette levier)</b>                      Handles &amp; O-Rings                      Manijas y Anillo "O"                      Manettes et Joint torique</p> 	<p><b>RP101184▲</b>                      Cap and Friction Ring (1)                      Tapa y aro de fricción (1)                      Chapeau et anneau de friction (1)</p> 
<p><b>RP100928▲</b>                      Button Post (4)                      Botón de correos (4)                      Bouton poste (4)</p> 	

▲ Specify Finish / Especifique el Acabado / Précisez le Fini