

FVN5024
QUADRO
INSTALLATION GUIDE

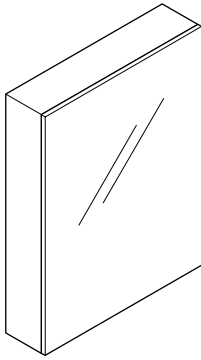

Medicine Cabinet
(Optional)

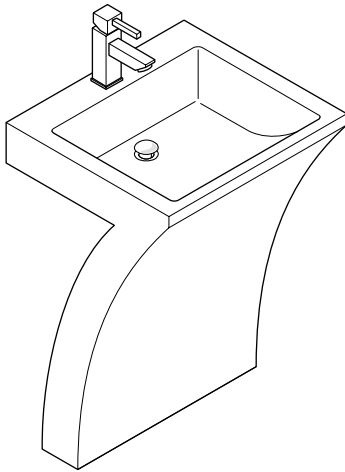
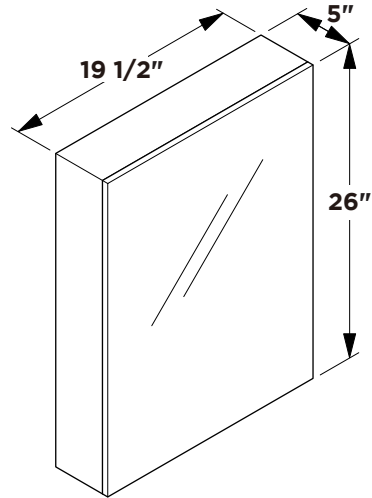

Vanity Front

Vanity Back

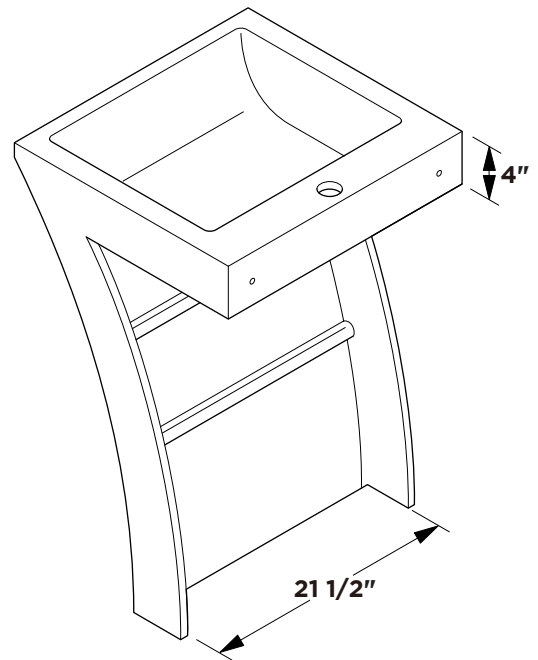
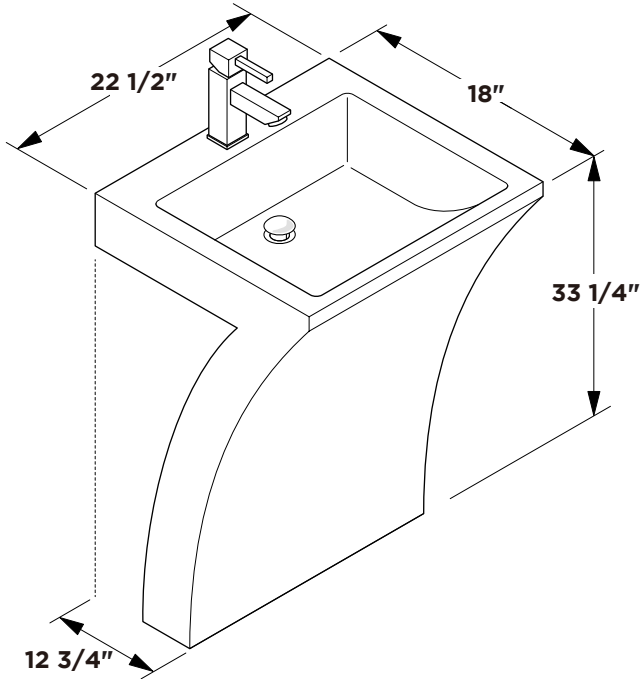

Note: All dimensions and specifications are approximate and subject to change without notice.

TOOLS FOR ASSEMBLY

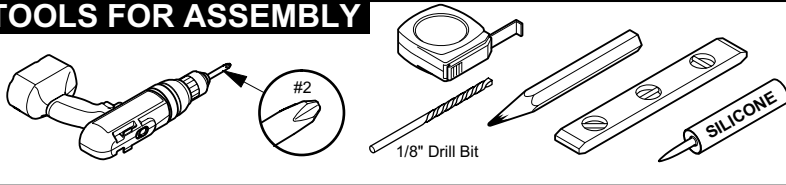

PARTS

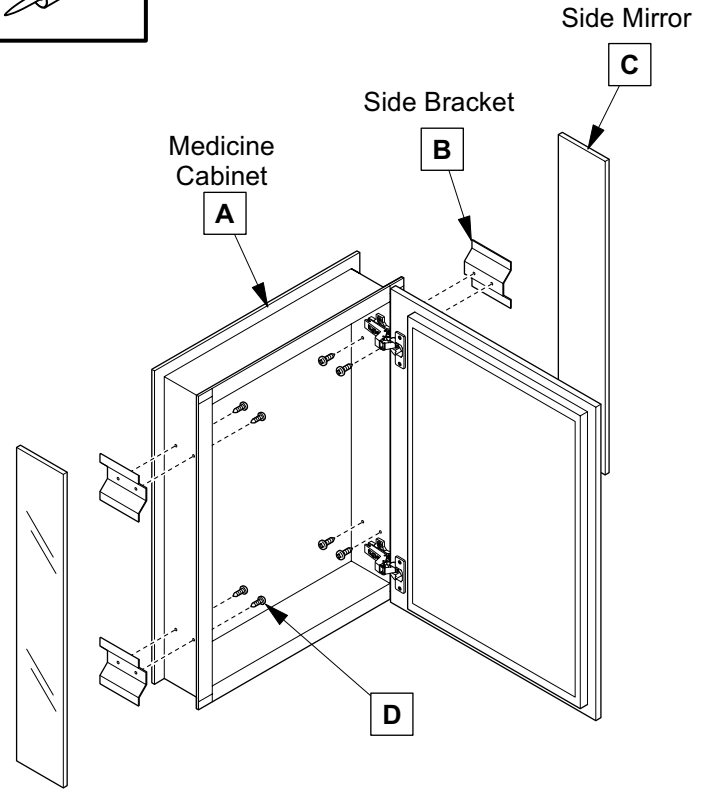
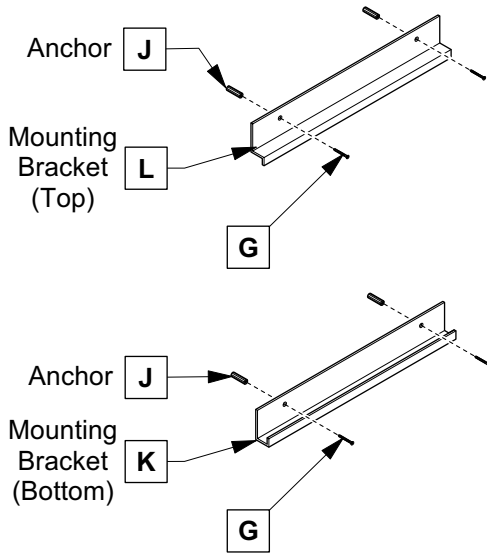

1 Install vanity (E)

IMPORTANT: Consult an expert for the proper screws/bolts to use when attaching to various wall constructions. Screws provided do not attach to all wall construction types.

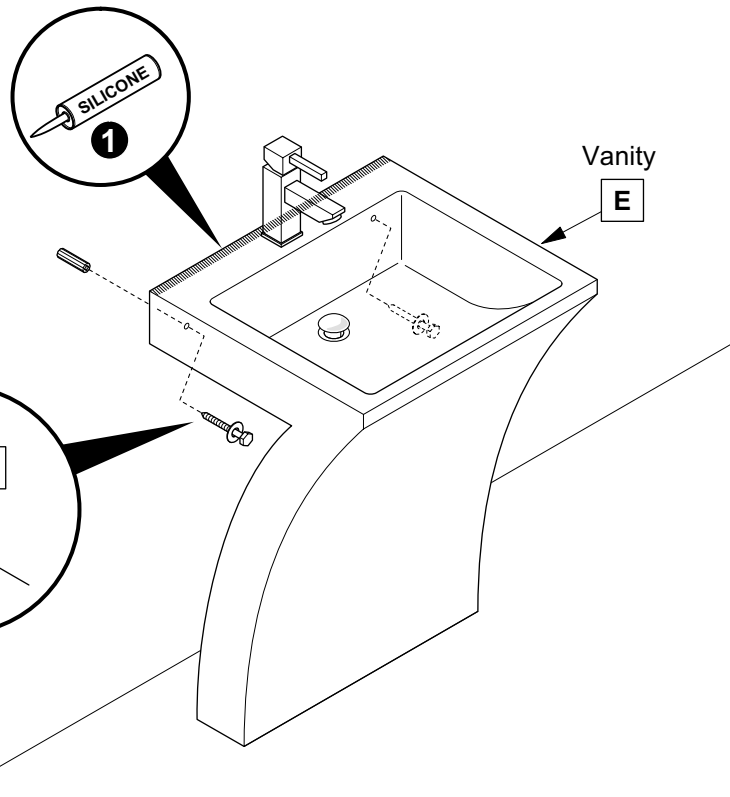

NOTE: Only use anchors (J) if stud (2"x4" frame) is not available.

MEDICINE CABINET INSTALLATION

1 Install side brackets (B)

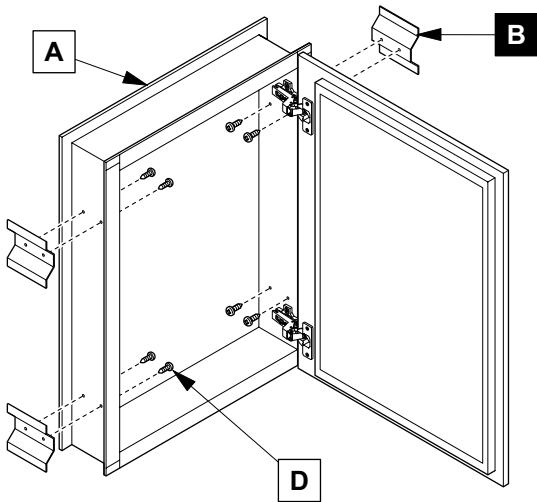

2 Install side mirrors (C)

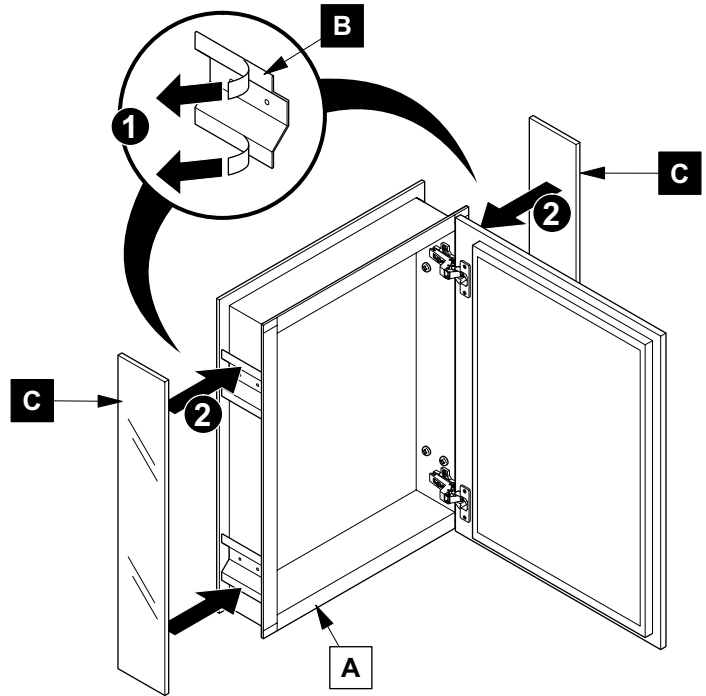

3 Mark cabinet (A) location

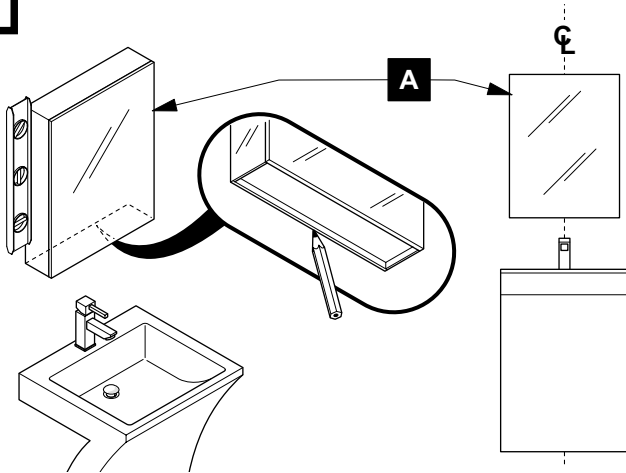

5 Install cabinet (A)

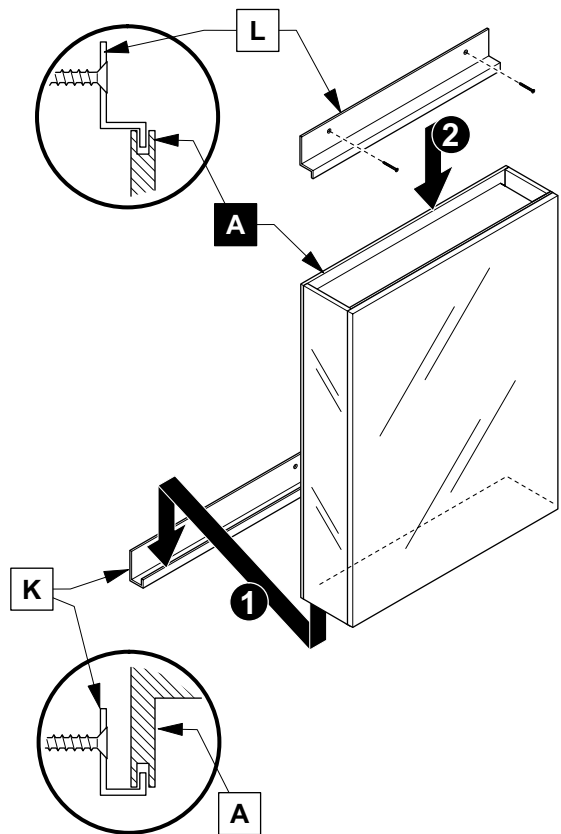
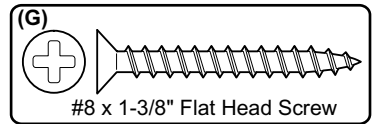

4 Install bottom bracket (K)

IMPORTANT: Consult an expert for the proper screws/bolts to use when attaching to various wall constructions. Screws provided **do not** attach to all wall construction types.

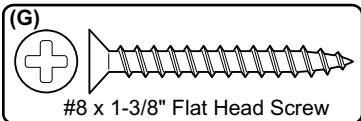
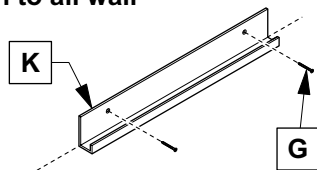

P-TRAP AND POP-UP INSTALLATION INSTRUCTIONS

Your item may appear slightly different from the illustration

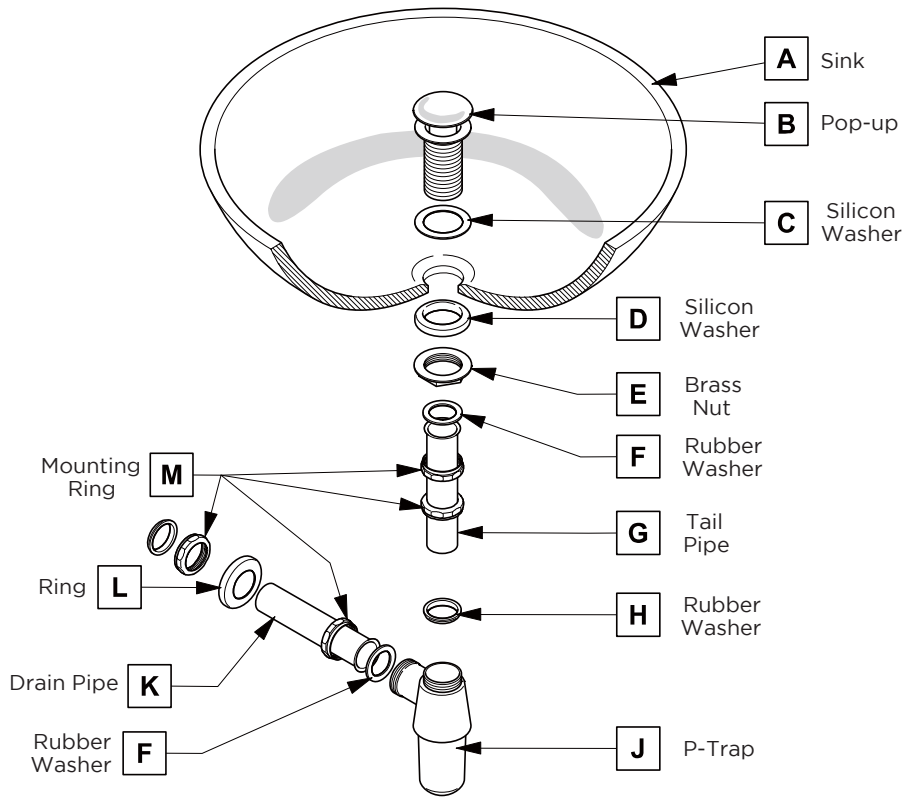

POP-UP INSTALLATION

FOR SINKS WITHOUT OVERFLOW

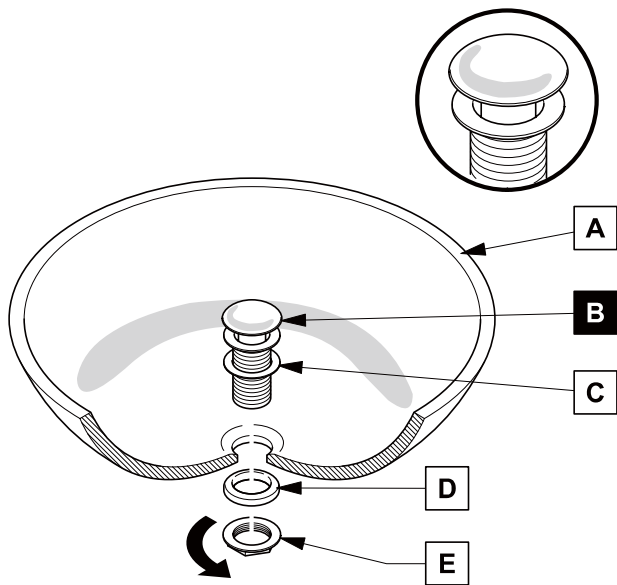

OR

FOR SINKS WITH OVERFLOW

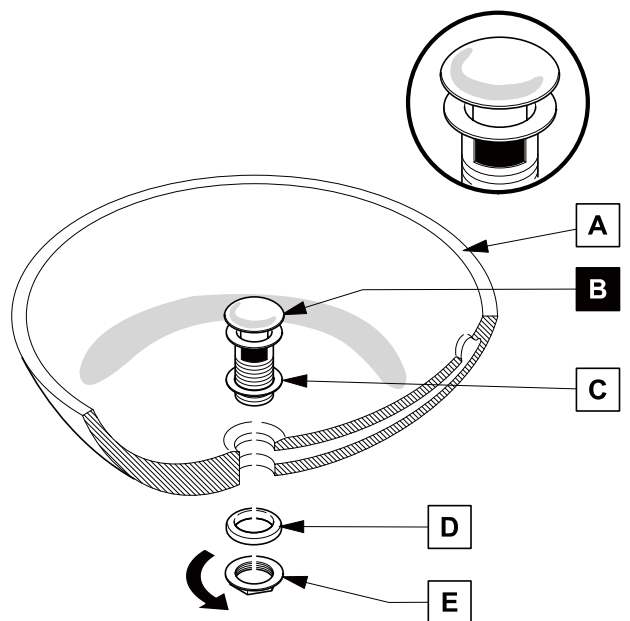

P-TRAP INSTALLATION

1

Install tail pipe (G)

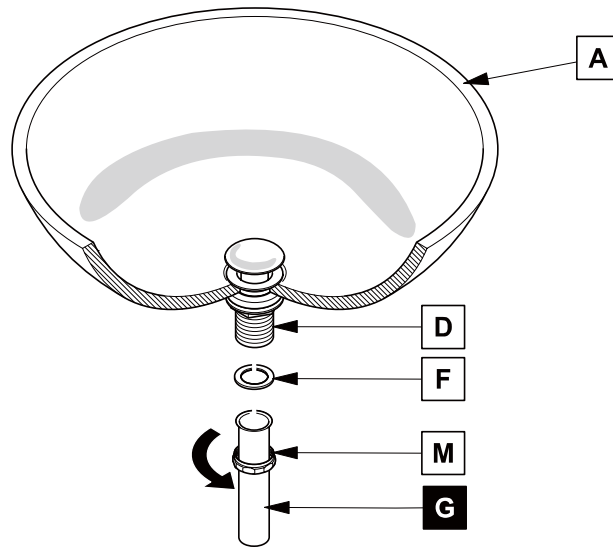

2

Install p-trap (J)

