

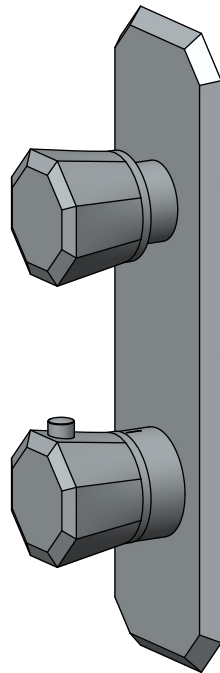

Installation Manual - 230.4000VT

Thermostatic Valve Trim & Handle Set

Use With TVH.2693, TVH.2717F & TVH.2705F Valves



BEFORE YOU BEGIN

- You must observe all local plumbing laws and codes.
- Do not install this valve if it does not meet local plumbing codes.
- Shut off the main water supply.

INSTALLING THE TRIM - TRIM PLATE SIZE AND SHAPE MAY VARY - ILLUSTRATION ONLY

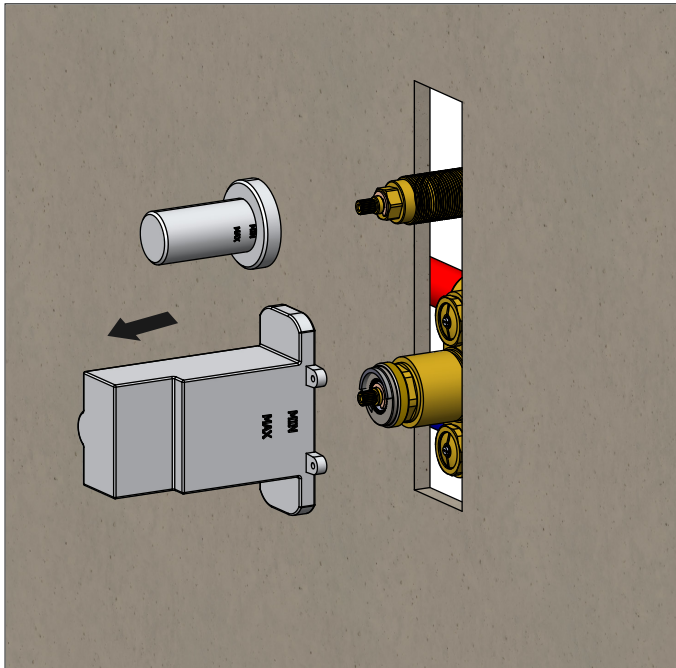

Remove mud guards

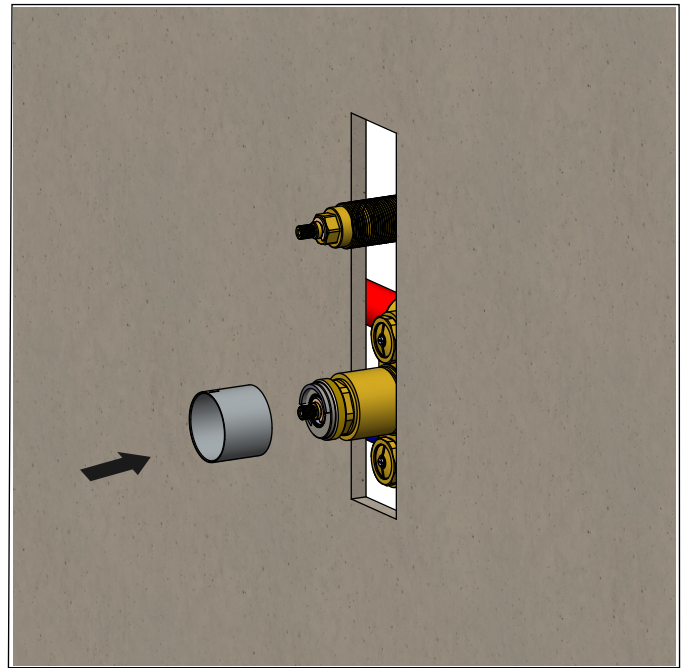

Install 42mm ring

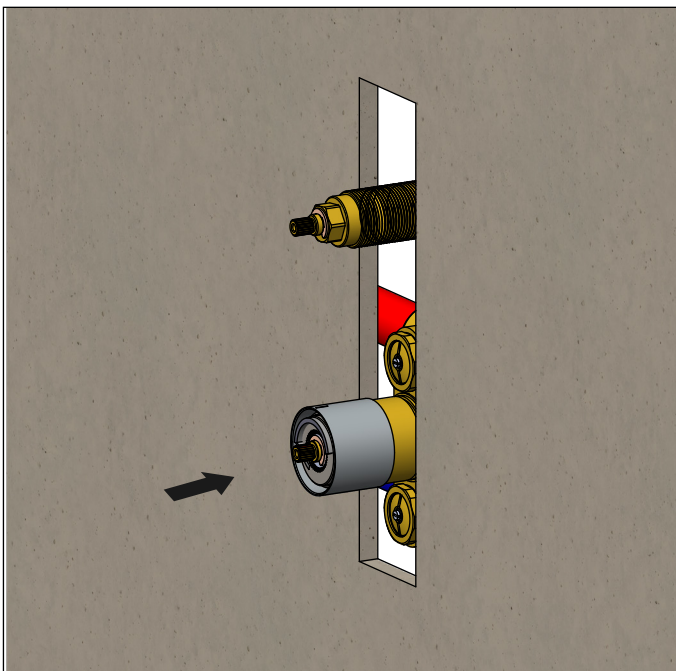

A hard push may be required

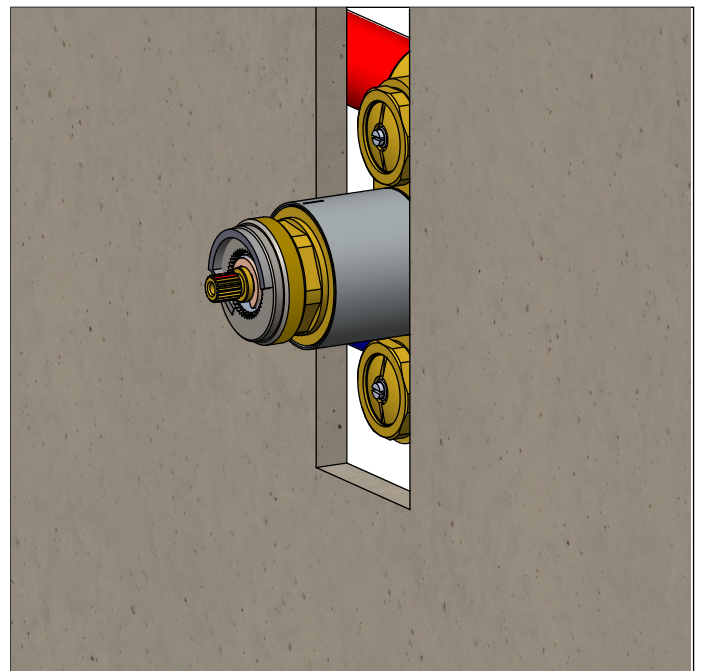

The 42mm ring must be flush. Otherwise the handle will not fit properly

INSTALLING THE TRIM - TRIM PLATE SIZE AND SHAPE MAY VARY - ILLUSTRATION ONLY

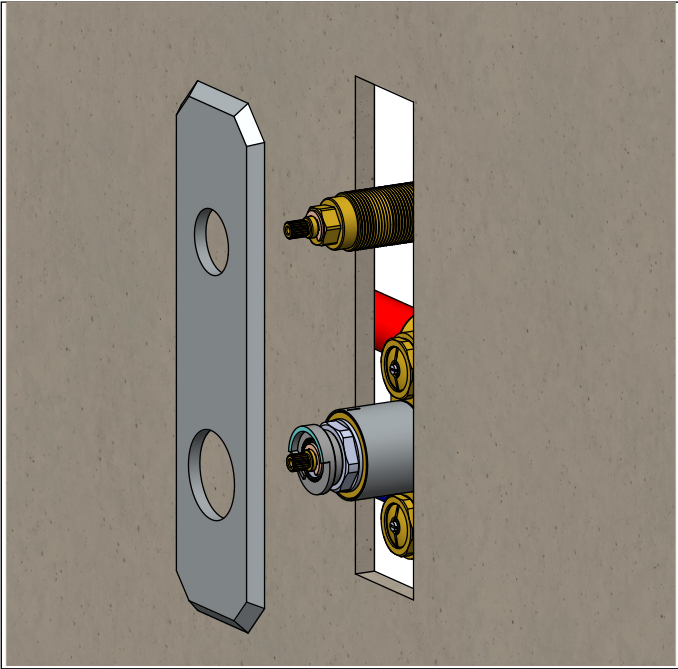

Insert trim plate

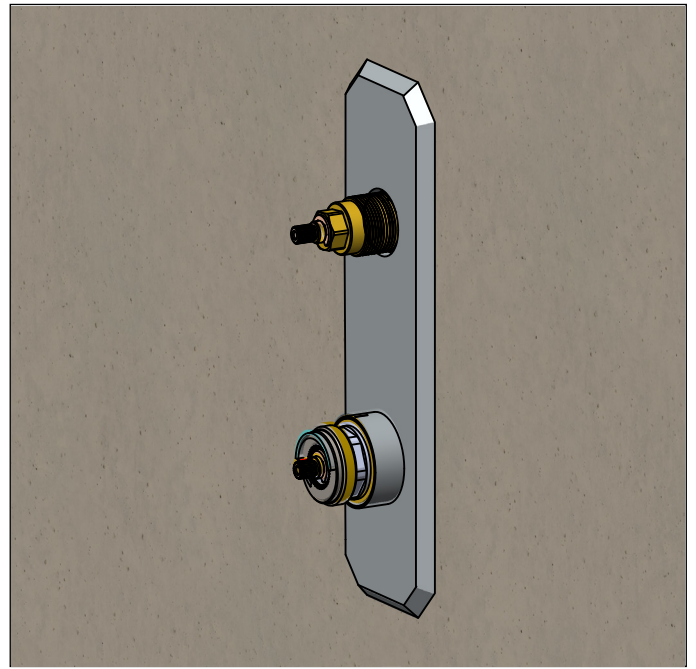

Align Trim plate till it is straight

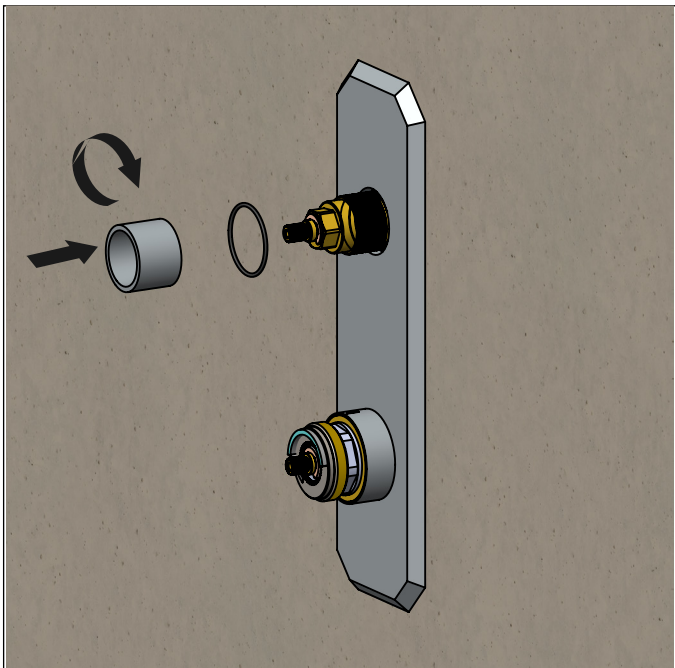

Insert adapter base and tighten

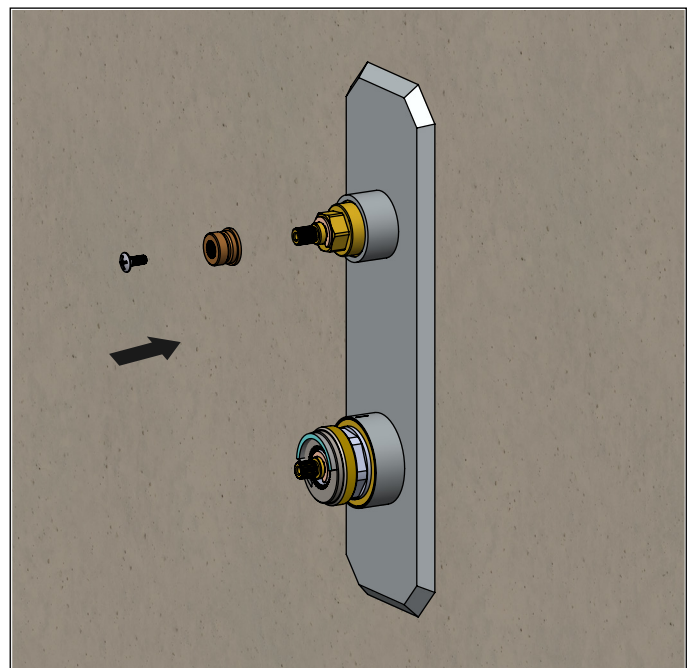

Insert centring knob & screws

INSTALLING THE TRIM - TRIM PLATE SIZE AND SHAPE MAY VARY - ILLUSTRATION ONLY

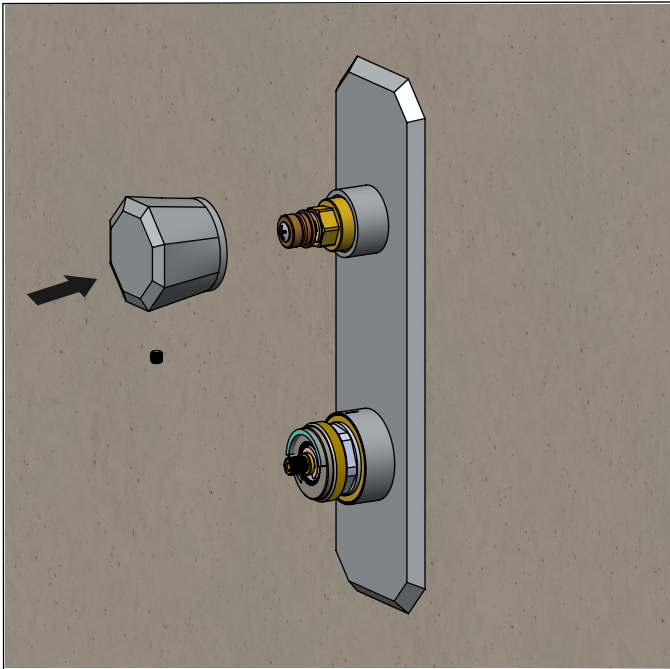

Insert volume handle. Tighten hex screw & insert cover button

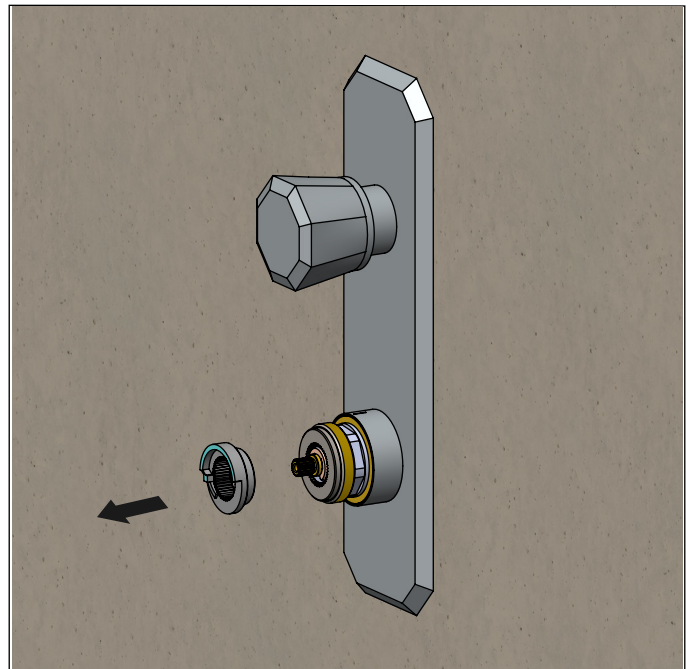

Remove anti-scald temperature ring and reinsert in correct position - see next image

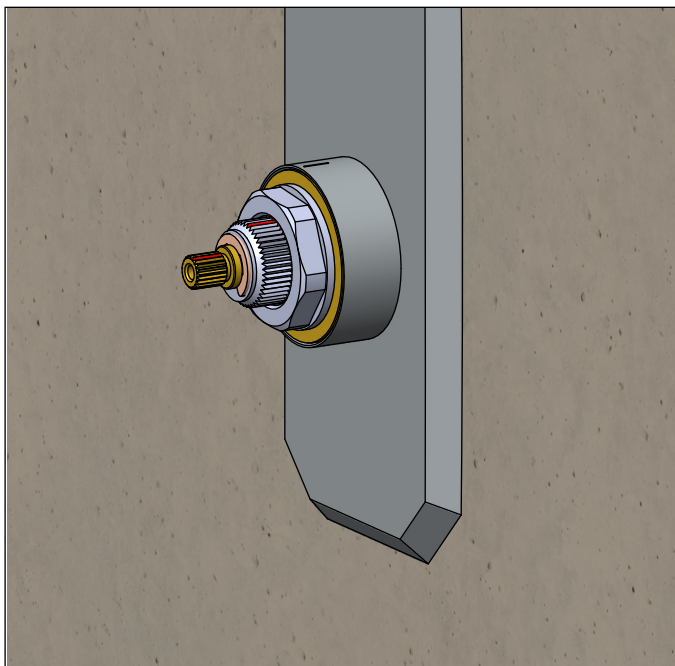

Caliberate cartridge before inserting temperature handle. Red marks must align.

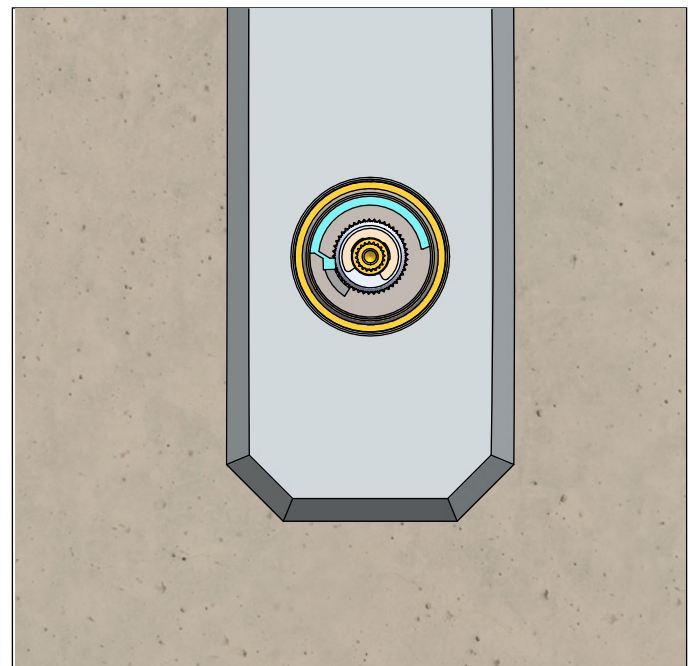

Correctly re-insert anti-scald temperature ring in the right position

INSTALLING THE TRIM - TRIM PLATE SIZE AND SHAPE MAY VARY - ILLUSTRATION ONLY

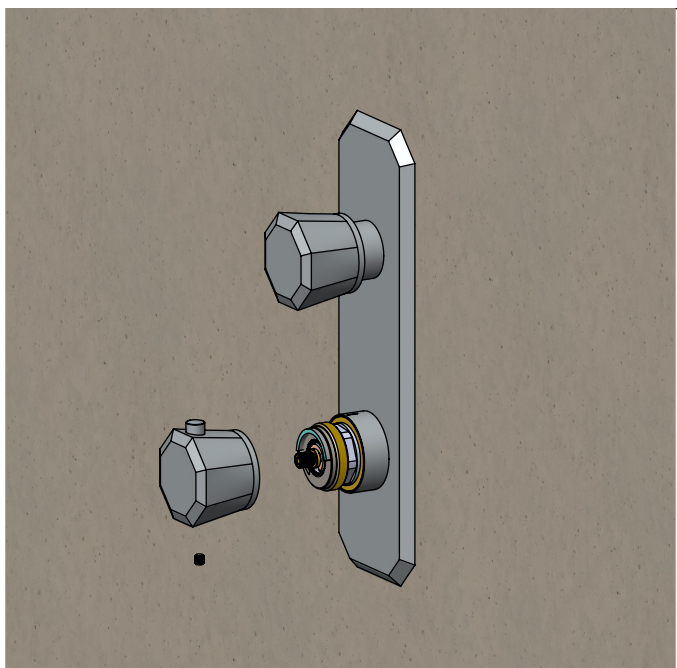

Insert temperature handle. Tighten hex screw & insert cover button

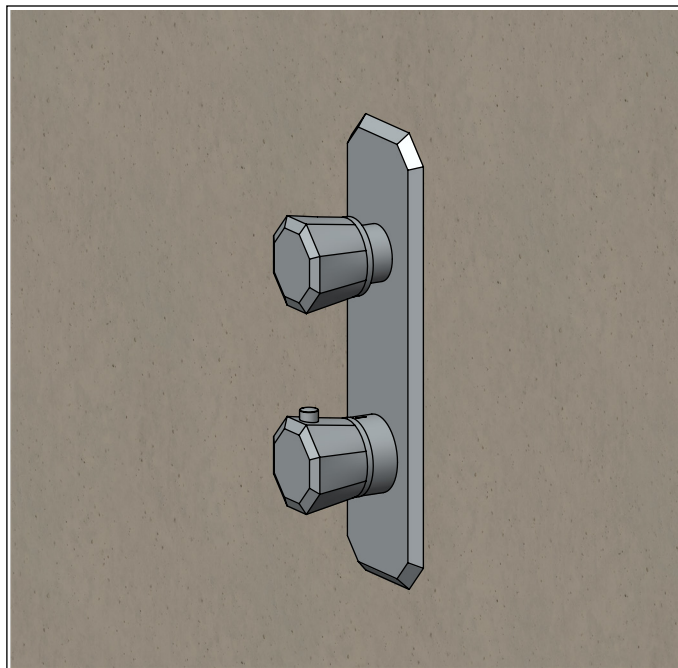

This photo shows a completely installed trim