

**SDH.1000 | 8" Square Pull Handle**

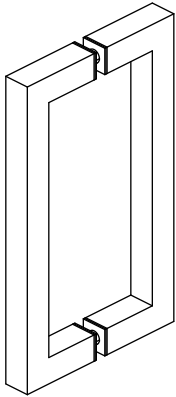

**SPECIFICATIONS:**

- Solid Brass construction
- Fits 3/8" to 1/2" Thick Glass
- Mounting Centre to Centre: 8"
- Handle Thickness: 19mm

**Technical Diagram**

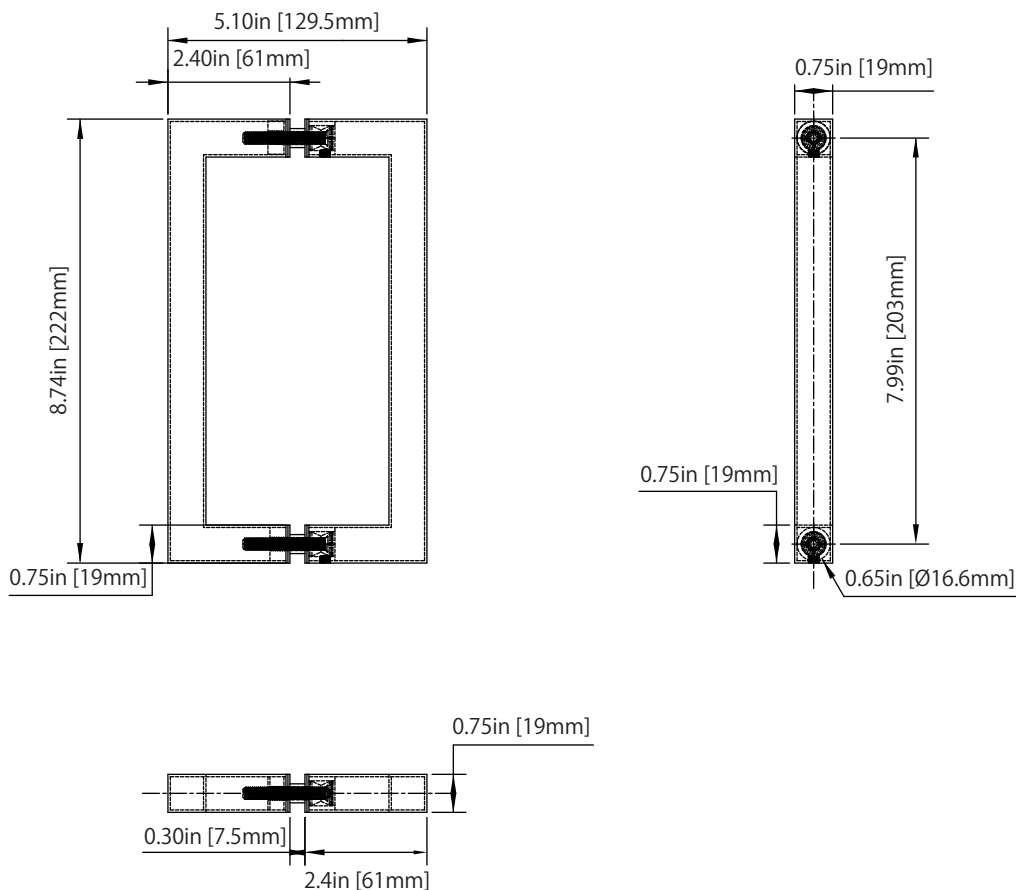

**GLASS CUTOUT DETAILS**

8" Square Pull Handle

Item No: SDH.1000

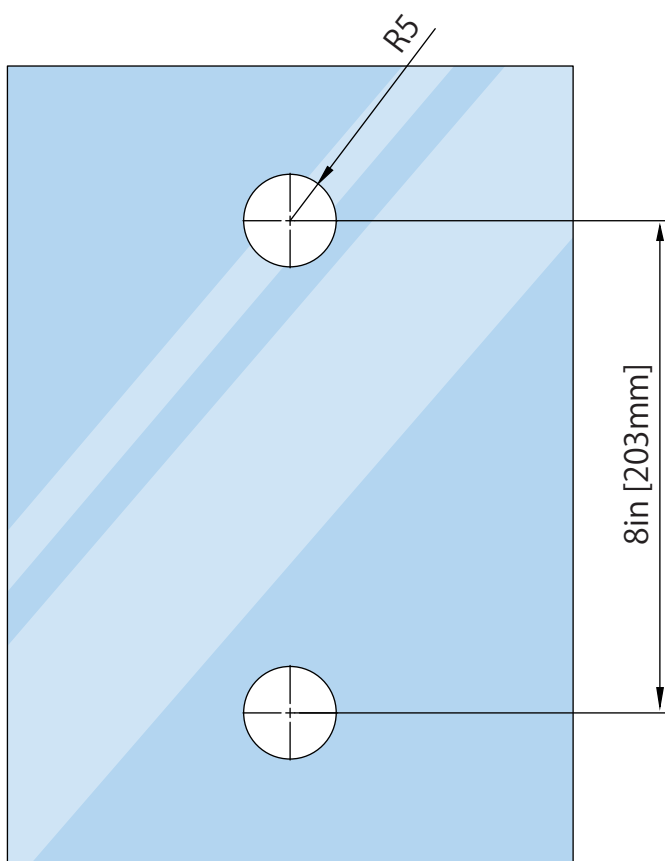

Tolerance :  $\pm 0.1$   
Glass Thickness: 3/8in [~10mm] to 1/2in [~12mm]

**CARE & CLEANING GUIDELINES:**

For optimal maintenance of your shower door hardware, adhere to the following guidelines:

- Regularly dry your shower door with a soft towel or cloth to preserve its original finish.
- Avoid using harsh cleaners or chemicals on the hardware, as the components may be coated with a clear lacquer that can incur irreparable damage.
- Prior to cleaning the entire hardware surface, conduct a patch test with your chosen cleaning solution in an inconspicuous area.
- Clean surfaces with a soft, dampened cloth or sponge, and thoroughly rinse with warm water after applying a small amount of gentle cleaning solution.
- Under no circumstances should abrasive products, sponges, or wire scrub brushes be used during the cleaning process.

**FRONT VIEW**

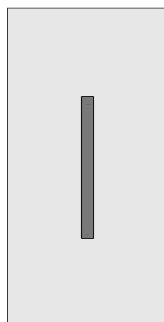

**SIDE VIEW**

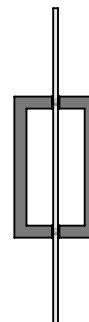

**FIT REPRESENTATION**

