

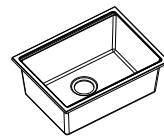

Installation Guide

Quartz Kitchen Sink



K4-S23T

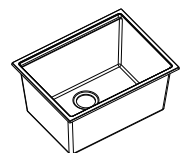

K4-S25T

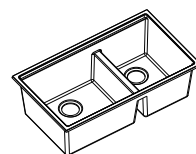

K4-D33T

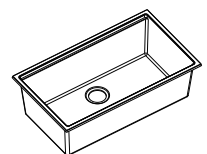

K4-S33T

Quartz Kitchen Sink

Installation Instructions

Thanks for choosing KIBI products. You have chosen one of our impeccable Fireclay sinks, and we are excited to get you started on installing it.



READ ALL INSTRUCTIONS BEFORE UNPACKING THE PRODUCT



I. Important

- 1- Read the instruction carefully before installation. Inspect the sink prior to installation to make sure that is not been damaged during shipping.
 - 2- The instructions are for installation with solid surface and composite material countertops. KIBI recommends professional stone fabricator to perform the installation and is not responsible for damage to countertop or sink during installation.
 - 3- Template are only provided as a guide. Place template on sink to ensure the template will give you the proper cutout for the sink.
 - 4- Observe all local plumbing and building codes.
 - 5- Keep this booklet and the receipt (or other proof of date and place of purchase) for this product in a safe place. The receipt is necessary to request warranty parts.
 - 6- KIBI does not accept any liability for damage to countertop, sink fixture, faucets or personal injury during installation. Warranty is void if installation guide is not followed.
- Please keep the box and packaging materials until your product is completely installed.**
- NOTE: These sinks are intended for indoor kitchen use only. They are not rated for outdoor use. Installation of this sink in an outdoor setting will void any warranty on this product.**

II. Tools you may need



1. Drill

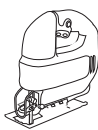

2. Jig Saw

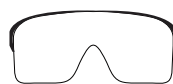

3. Safety Glasses

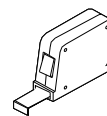

4. Tape Measure



5. Pencil

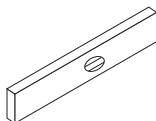

6. Level

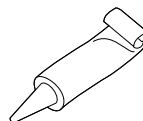

7. Silicone

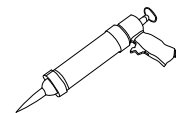

8. Silicone/Caulk Gun

III. Installation Options

KIBI Undermount sinks can be installed in two different types:

Use scissors to cut along the line of paper template for your desired reveal type (Positive or Flushed reveal).

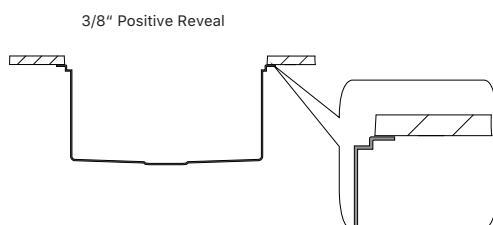

KIBI Recommended Installation type

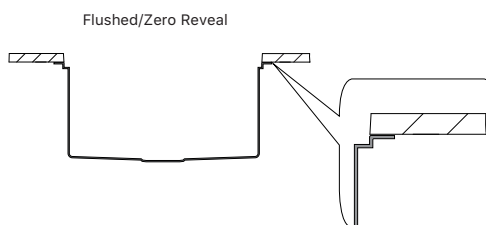

Flush installation: Countertop edge and sink edge are in alignment for a continuous look.

Positive installation: Countertop rim is cut back 3/8" from sink sides to reveal the sink edge.

Caution: When determining sink placement, be sure to check that there is adequate clearance behind the sink for any faucet(s) and your backsplash, as well as clearance for a full range of motion for faucet spouts and handles.

IV. Undermounted installation

Step 1: Position Template

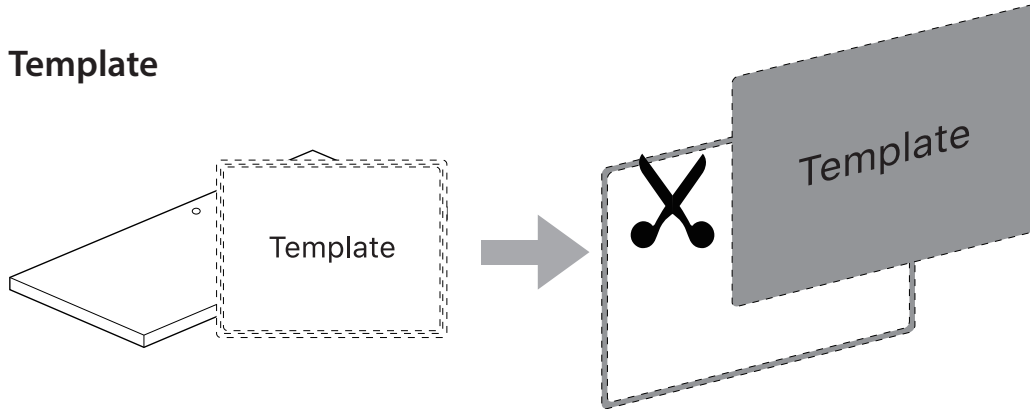

Unpack the new sink and check the contents of the materials supplied: Sink, Mounting brackets, and Cutout template (depending on model). Contact your retailer if any product is damaged or missing prior to installation. Never install a damaged sink as it can void your warranty.

Determine the installation type you prefer, cut out the appropriate template for your sink model.

⚠ **Make sure clearance is suitable for backsplash, faucet, and plumbing for the sink.**

Step 2: Trace Template and Cut Countertop

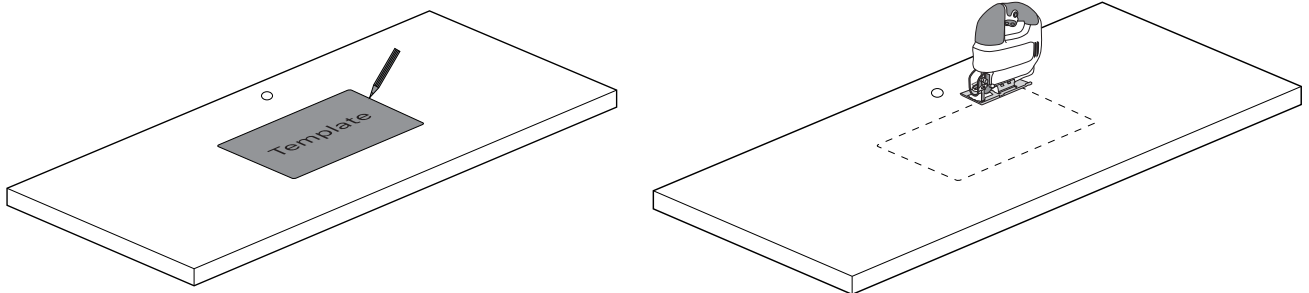

Trace template on countertop with a pencil.

Cut the opening in the countertop by carefully following the traced line.

⚠ **NOTE: Please use the appropriate saw that best fits your countertop material.**

Step 3: Set up Mounting Brackets

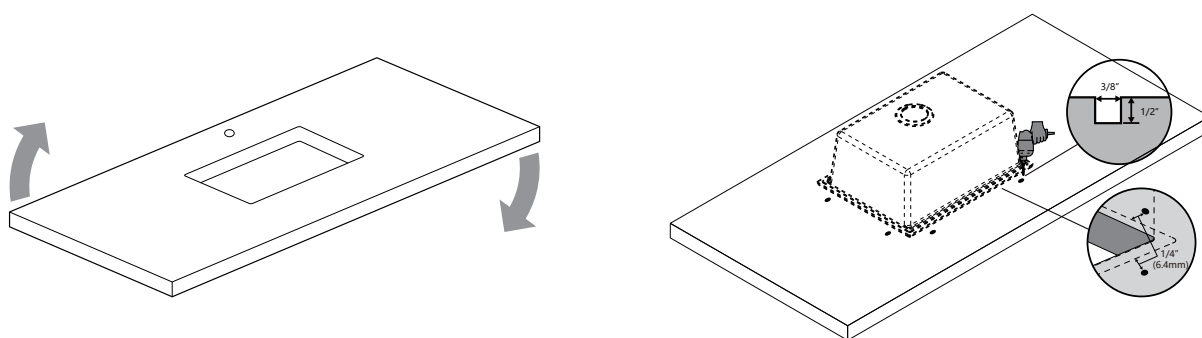

Turn countertop over and align sink with countertop.
Decide location for mounting brackets, drill 3/8"X1/2" deep hole in the countertop.

Step 4: Install Anchors

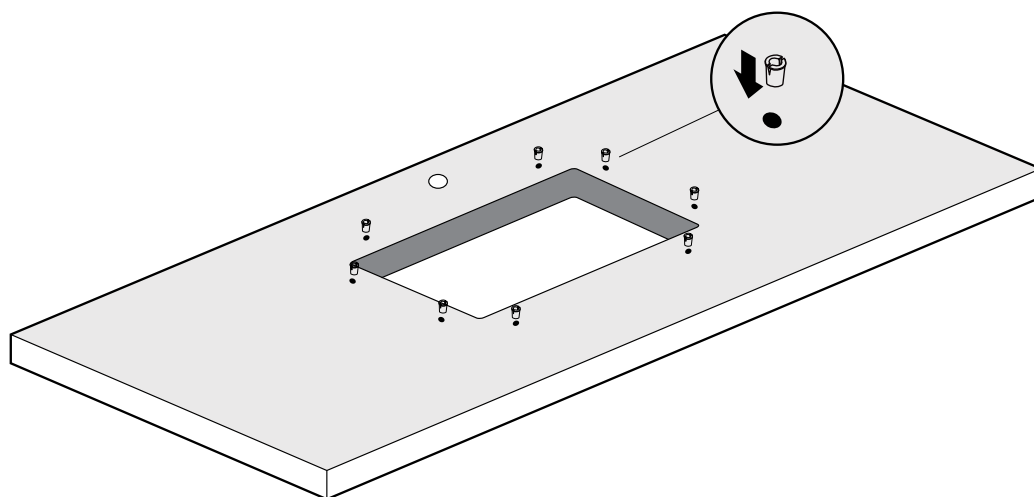

Install anchors into drilled holes and lightly tap with a hammer until flush.

Step 5: Secure Sink to Countertop

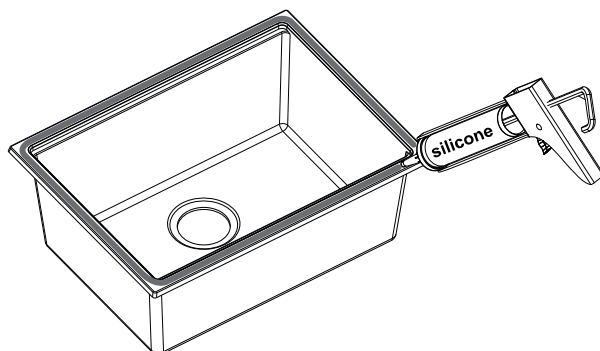

Apply a bead of silicone adhesive (not included) to the sink edges.

⚠ **Do not use epoxy.**

Step 6: Position the Sink

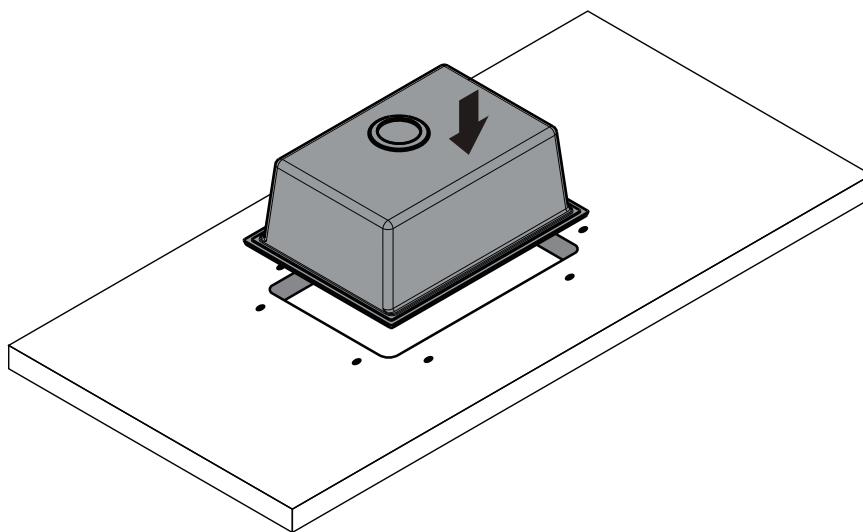

Position the sink in the opening.

Step 7: Attach Mounting Hardware

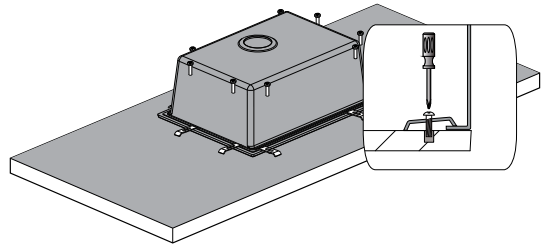
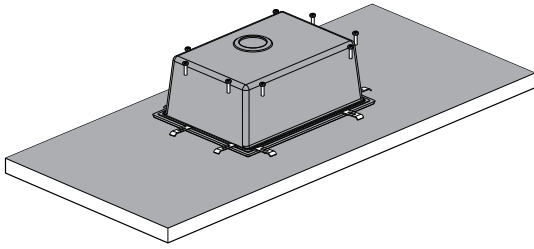

Tighten the fasteners until just snug.
Check the alignment of the sink in the opening.
Tighten the mounting hardware evenly.

Step 8: Install Plumbing Fixtures

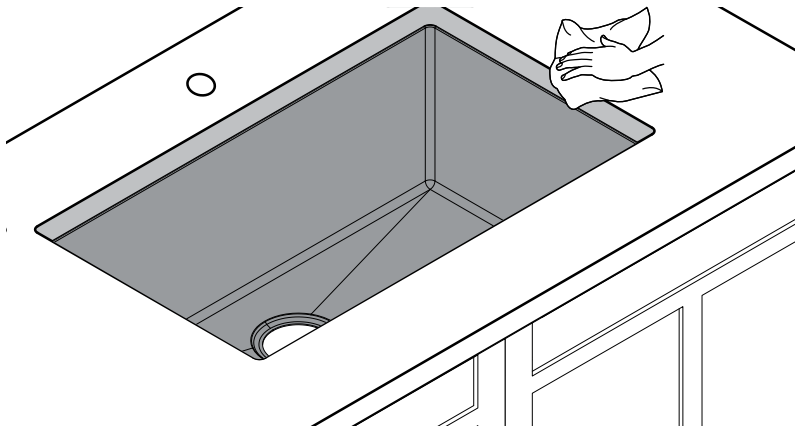

Wipe off any excess caulk.
Connect drain to sink. Connect trap to drain.
Connect water supply connections to faucet according to manufacturer's instructions.
Run water into sink and check for leaks.

⚠ **Allow the caulk to cure according to the manufacturer's instructions before using the sink.**

VI. Products Care and Maintenance

Clean your sink on a regular basis with warm soapy water. Rinse the sink after using cleaning products. Wipe the sink surface with a soft cloth to remove any liquid residue. Do not cut food directly on the surface of the sink. Do not leave sharp objects on the surface of the sink for an extended period of time. Do not use abrasive cleaning products, sanding tools, steel wool, or bleaching products

VII. KIBI Limited Lifetime Warranty

This product has been manufactured and inspected to the highest possible quality standards. Kibi sinks carry a limited lifetime warranty for residential use.

Should you experience any defects in materials or workmanship within the warranty period, we will repair or replace the defective product, subject to the following conditions:

- Any claim made under this warranty must include a copy of a valid proof of purchase showing the date and place of purchase.
- Our obligation under this warranty is to the original purchaser only, and may not be transferred.
- Product replacement does not include shipping costs or labor installation costs.
- This warranty applies to residential installations only.
- Kibi reserves the right to examine product in question and its installation prior to replacement.
- If an identical replacement product is not available, Kibi reserves the right to replace the defective product with a similar product.

NOTE: Accessories such as rinse grids, cutting boards, strainers are not covered by this warranty.

This warranty relates to defects in manufacture, materials or workmanship in a Kibi stainless steel kitchen sink supplied for installation into domestic premises in the United States. It does not extend to :

- Damage resulting from failure to maintain the product in accordance with the Care and Maintenance instructions in this manual.
- Normal wear and tear, scratches or accidental damage.
- Faults arising from improper use and/or installation.
- Defects in accessories, strainers and rinse grids.

All incidental or consequential damages are specifically excluded. No additional warranties, express or implied are given, including but not limited to, any implied warranty of merchantability or fitness for a particular purpose.

Some states do not allow the exclusion or limitation of incidental or consequential damages or limitations on how long an implied warranty lasts, so the above limitations or exclusions may not apply to you.

This warranty gives you specific legal rights, and you may also have other rights which vary from state to state.