

Tools you may need



Wrench



Pencil



Tape Measure



Square



Level



PVC Cement



Utility Knife

PARTS Included In the Package

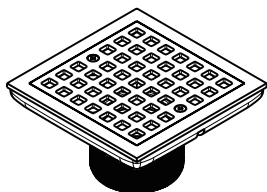

Strainer Body Assembly

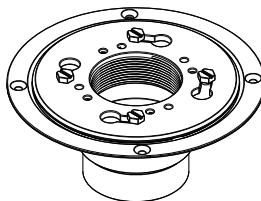

Flange Adapter Assembly

Before Installation



Failure to read these instructions prior to installation may result in personal injury, property damage, or product failure. Manufacturer assumes no responsibility for product failure due to improper installation.

IMPORTANT SAFETY INSTRUCTIONS

- Adhere to all applicable local plumbing and building codes.
- A professional mason and plumber are strongly recommended for the installation of this product.
- It is advised to follow the enclosed installation procedures. Alternative installation methods may be suitable depending on your circumstances.
- Prior to installation, frame in the shower alcove, install the curb, and install 2x10 lumber in the stud bays around the perimeter of the shower base.
- These instructions offer guidance for rough construction and plumbing installation. Local building codes may differ and take precedence over these guidelines. If you are uncertain about performing these tasks, consider hiring a professional installer or subcontracting as necessary.

Plumbing:

- Verify that your model fits the intended location and the drain pipe outlet is correctly positioned before starting the installation.
- The minimum size for a new installation shower trap drain is 2 inches.
- Ensure the shower drain pipe has a gradient of 1/4 inch per foot for proper drainage.
- Allow the product to acclimatize to room temperature for 30 minutes prior to installation.



DO NOT RETURN TO STORE

If you have any trouble, contact us before reaching out to the retailer. we'll make it right. Our customer service team will be glad to assist you with any assembly, missing part or questions that you may have about your products.

Contact KIBI 📞 **855-883-0888** ✉️ **support@kibiusa.com** 🌐 **www.kibiusa.com**

Critical dimensions show in mm

KFD0401

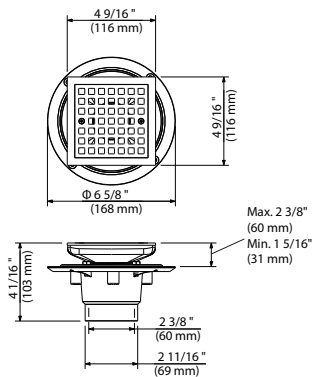

KFD0402

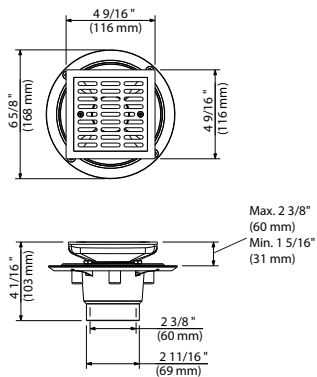

KFD0403

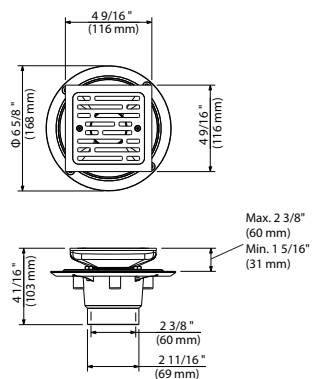

Installation

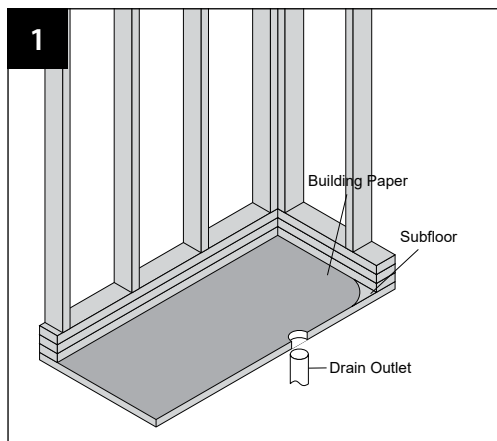

Building Paper Layer

1. Staple building paper to the subfloor of the shower base. Do not cover the drain outlet with building paper.

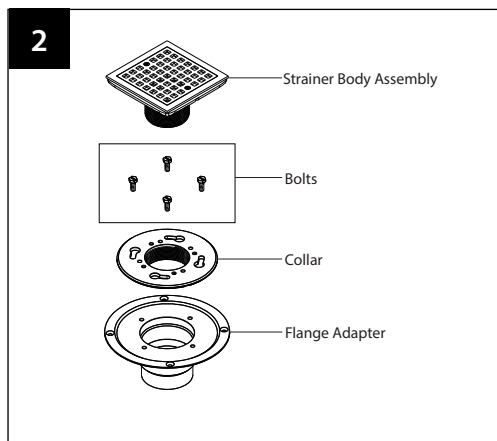

Prepare Tile-In Drain

1. Remove the screws from the strainer plate. Set the screws, plate, ring, and body aside.
2. Remove the screws from the collar to separate the collar from the flange adapter. Set the screws and collar aside.
3. Apply PVC cement to the outside of the flange adapter where the flange adapter and drain outlet will meet.
4. Insert the flange adapter into the drain outlet.
5. Partially thread the four screws into the flange adapter.
6. Place a rag in the drain outlet to prevent mortar from falling into the drain outlet.

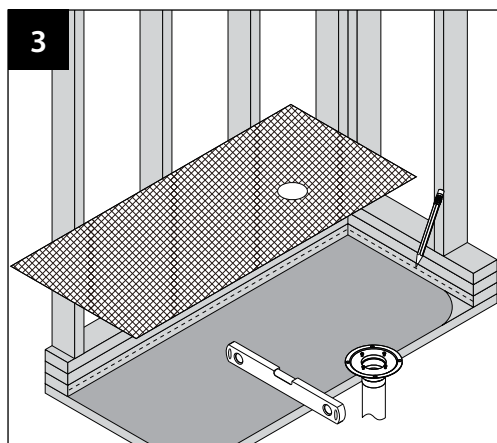

Galvanized Lath Layer

1. Measure height from the bottom of the lower body of the drain such that the mortar bed will be 1/4" per foot sloped (2% grade) from the wall framing to the edge of the Lower Body.
2. Using a level, mark this height around the perimeter of the shower base.
3. Staple galvanized lath over the building paper.
4. Cut a hole in the lath approximately 1/2" away from the edge of the Lower Body.

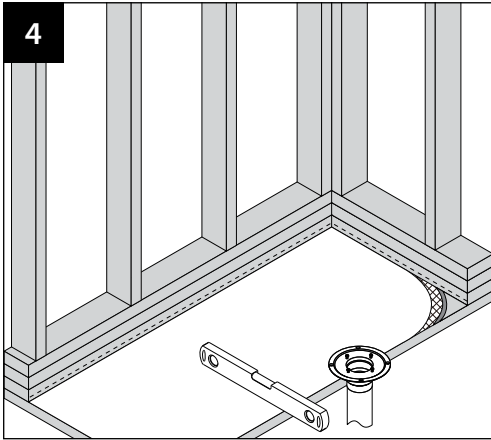

Mortar Layer

1. Trowel mortar from the outer edge of the Lower Body to the marked height on the perimeter of the shower base.
2. Verify the slope of the mortar is even. Fill in any low spots with mortar. Check the mortar is flush with the lower drain base.
3. Allow mortar to cure according to manufacturer's instructions

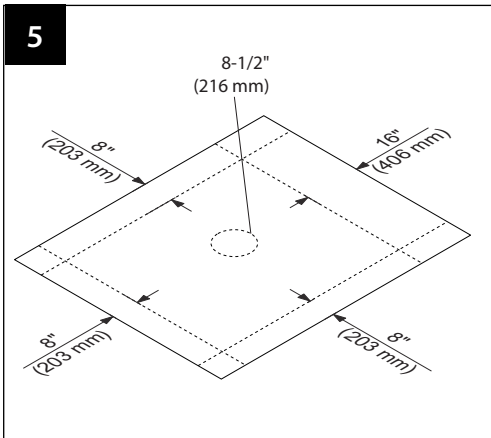

Prepare Waterproof Membrane

1. Determine the dimensions of the pan liner. Measure and mark the perimeter of the shower base on the waterproof membrane.
2. Mark an additional 8" (20.3 cm) out for each wall and 16" (40.6 cm) out at the curb.
3. Cut the waterproof membrane to size using a utility knife and straightedge. Do not puncture the waterproof membrane while cutting.
4. Mark the location of the Lower Body on the waterproof membrane.
5. Using a new or extra piece of waterproof membrane, cut a circle 2" larger than the marked circumference.
6. Adhere the circle over the marked circumference of the Lower Body using binding adhesive for PVC sheeting. Adhere to all manufacturer's instructions. Note: This step will reinforce the drain seal.

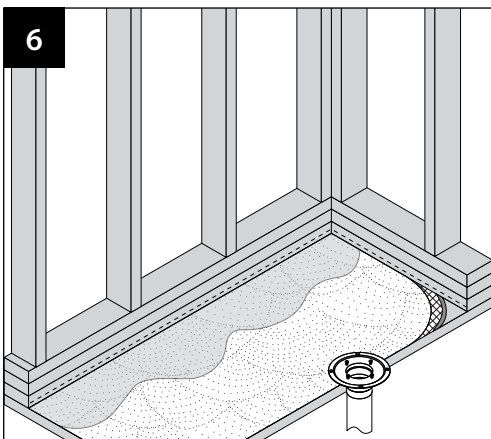

Laminating Adhesive Layer

1. Apply a laminating adhesive to the perimeter of the shower base, curb, and on top of the mortar following all manufacturer's instructions.
2. Apply CPE sealant around the drain 1" from the edge following all manufacturer's instructions for CPE sealant.

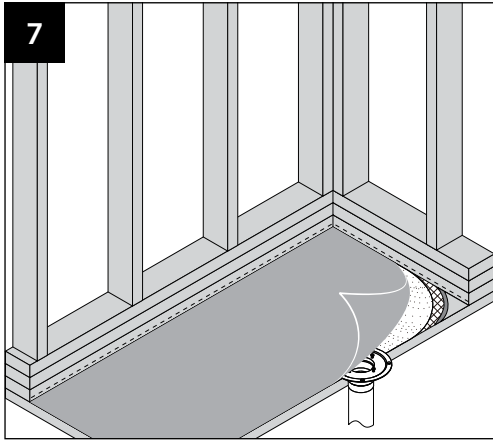

Waterproof Membrane Layer

1. Lift the waterproof membrane in place and align the center of the reinforced drain seal with the bolts in the Lower Body.
2. Working from the drain outlet to the walls, smooth out any bubbles from under the waterproof membrane.
3. Using CPE solvent, glue the backside of the waterproof membrane and adhere to the perimeter of the shower base. Follow all manufacturer's instructions for application and cure time. Ensure the waterproof membrane is tight in each corner.
4. Secure waterproof membrane to the perimeter at a minimum of 2" above the level of the curb using staples. Do not penetrate the pan liner below the curb.
5. Cut away the waterproof membrane at the bolts locations on the lower body by marking an X over the bolts. Push the bolts through the membrane.
6. Cut out the waterproof membrane at the drain outlet.

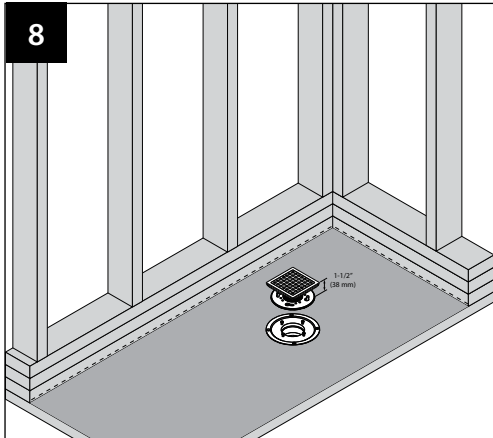

Assemble Drain

1. Measure the thickness of the tile, then determine the orientation of the collar. Note: Threads should be facing down. Refer to image in section B for reference.
2. Place the collar over the bolts, then lock the collar in place by rotating. Ensure the flange height remains flush to pan liner.
3. Secure the collar to the flange adapter. Do not over-tighten the bolts.
4. Test the pan liner to be sure it is water tight by plugging the drain body outlet and filling shower floor with water. Conduct test according to local codes. Once tested remove plug and drain water.
5. Apply patches of waterproof membrane and CPE solvent, if necessary.
6. Install cement board in accordance with manufacturer's instructions.
7. Prepare the curb for installing the tile.
8. Thread the upper body assembly to the lower body until the top of the upper body is a minimum of 1-1/2" (3.8 cm) above the shower base. NOTE: For applicable finishes be sure the texture direction of the ring and drain grate flow in the same direction when determining placement.
9. Measure and mark 1 1/2" up the wall from the base of the shower.
10. Using a level, mark this height around the perimeter of the shower base.

9

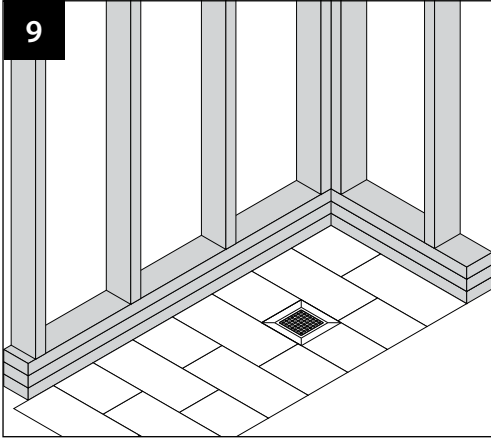

Tile Layer

1. Identify the proper drain cover height by rotating the upper body assembly with the tile in frame to the height of the finished flooring. Raise or lower as needed.
2. Before application of the mortar bed, place pea gravel over the weep holes. This will prevent mortar from plugging the holes.
3. Using mortar, build the shower base up approximately half way between the shower base and the marked perimeter.
4. Cover the mortar bed with metal lath, keeping the metal lath 1/2" (1.3 cm) away from the Upper Body Assembly.
5. Using mortar, build up the shower base up to the marked perimeter. Slope the mortar lower around the strainer ring to allow space for the thickness for the tile.
6. Allow the mortar to cure overnight before installing the tiles.
7. Install the floor tile using a thin set mortar following all manufacturer's instructions. Repeat step for shower alcove.
8. Grout and seal all tile according to manufacturer's instructions

LIMITED LIFETIME WARRANTY

KIBI provides its customers with an extensive warranty as a result of our excellent workmanship and high quality components used in our products.

Mechanical warranty: A limited lifetime warranty is provided on all mechanical parts to be free from manufacturing defects in materials and workmanship under normal use for as long as the original purchaser owns their home.

Finish warranty: A 5-year warranty is provided on all KIBI shower drain finishes to the original purchaser against manufacturing defects in materials and workmanship.

At its sole discretion, KIBI will repair or replace any part or finish that proves to be defective in material and/or workmanship under normal installation, use and service.

This warranty is extended to the original consumer owner, but does not cover installation or any other labor charges. In no event shall KIBI be liable for any incidental, consequential or special damages, installation cost, labor, travel time, freight costs incurred, lost profits, or contingent liabilities. KIBI makes no representation that its products comply with any or all local building or plumbing codes. It is the consumer's responsibility to determine local code compliance.