

NOTE(S):  
 1. APPLY NSF COMPLIANT LOCTITE TO THREADED AREA. L

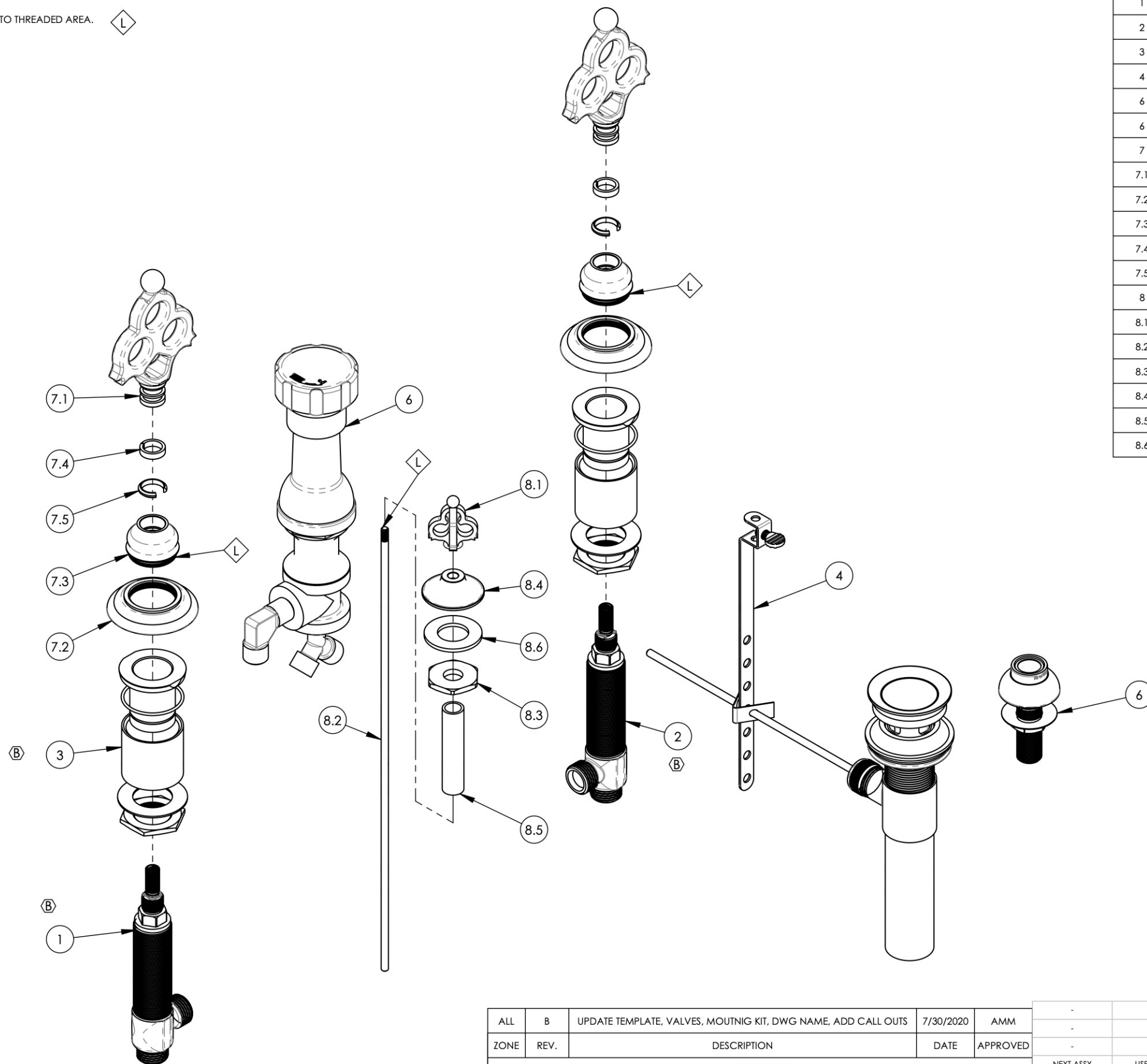

ITEM NO.	PART NUMBER	DESCRIPTION	QTY.
1	1-149	WIDESPREAD VALVE LAV 16PT, HOT, ONLY	1
2	1-150	WIDESPREAD VALVE LAV 16PT, COLD, ONLY	1
3	2-092	RECESSED MOUNTING KIT FOR WIDESPREAD	2
4	3-046/00	POP-UP DRAIN ASSEMBLY (2-101, 2-102, & 2-246)	1
6	3-085/00	ASSY, BIDET SPRAYER	1
6	3-160/00	BIDET DIVERTER, COMPLETE	1
7	3-328/00	FLAT HANDLE, TRADITIONAL	2
7.1	11159/00	HANDLE FLAT CROWN, TRADITIONAL	1
7.2	10620/00	ESCUTCHEON, TRADITIONAL RT 1-1/4"-20	1
7.3	11161/00	BASE HANDLE, TRADITIONAL	1
7.4	P35053	WEAR WASHER, WAVELAND HANDLE	1
7.5	P35052	SNAP WASHER, WAVELAND HANDLE	1
8	3-423/00	ASSY. BIDET POP-UP ROD, COURONNE	1
8.1	2-039/00	ASSY, POP-UP COURONNE SERIES	1
8.2	10719/00	POP-UP ROD, 10-24, 14" LONG	1
8.3	P09006	SPECIAL HEX F/BIDET SPRAYER	1
8.4	P09007/00	K4160 POP UP GUIDE	1
8.5	P32010	9/16-20 x 56 NIPPLE FOR COMPRESSION STEM	1
8.6	P35026	3/4" SAE FLAT WASHER	1

ALL	B	UPDATE TEMPLATE, VALVES, MOUTNIG KIT, DWG NAME, ADD CALL OUTS	7/30/2020	AMM
ZONE	REV.	DESCRIPTION	DATE	APPROVED
REVISIONS				
		1261 LOGAN AVENUE COSTA MESA, CALIFORNIA 92626 PHONE: 714.361.4800 FAX: 714.617.3120	<b>PHYLIRICH</b> Defining Luxury Since 1959	
		<b>PROPRIETARY AND CONFIDENTIAL</b> THE INFORMATION CONTAINED IN THIS DRAWING IS THE SOLE PROPERTY OF PHYLIRICH. ANY REPRODUCTION IN PART OR AS A WHOLE WITHOUT THE WRITTEN PERMISSION OF PHYLIRICH IS PROHIBITED.		

-	-	INTERPRET GEOMETRIC DIMENSIONING & TOLERANCING IN ACCORDANCE WITH ASME Y14.5-2009 & ASME Y14.41-2003 STANDARDS. UNLESS OTHERWISE SPECIFIED, DIMENSIONS ARE IN INCHES. TOLERANCES ARE:		
NEXT ASSY	USED ON	<b>FRACTIONS</b> ±1/16"	<b>DECIMALS</b> X.X: ±.1 X.XX: ±.01 X.XXX: ±.005	<b>ANGULAR</b> ±2°
APPLICATION		MATERIAL	NAME	DATE
FINISH		DRAWN	LLO	11/5/2015
<b>DO NOT SCALE DRAWING</b>		CHECKED	GRE	

<b>FOUR HOLE BIDET SET, BLADE HANDLES, MAISON</b>				
SIZE	ASM/PRT NO.	REV		
<b>B</b>	164-60/00	B		
SCALE: 1:3	WEIGHT: lbs.	SHEET 1 OF 2		