

- NOTE(S):
- EXAMPLE OF SPLIT FINISH CODE:
A. 161-03/026X030
 - LEVER HANDLE INSERT STONE OPTIONS:
A. BLACK MARBLE = 11328 (.../00X030)
B. WHITE MARBLE = 11329 (.../00X031)
C. SOAPSTONE = 11330 (.../00X032)
 - APPLY NSF COMPLIANT GREASE TO ANY O-RING, SEALING JOINTS, AND/OR PIVOTAL POINTS.

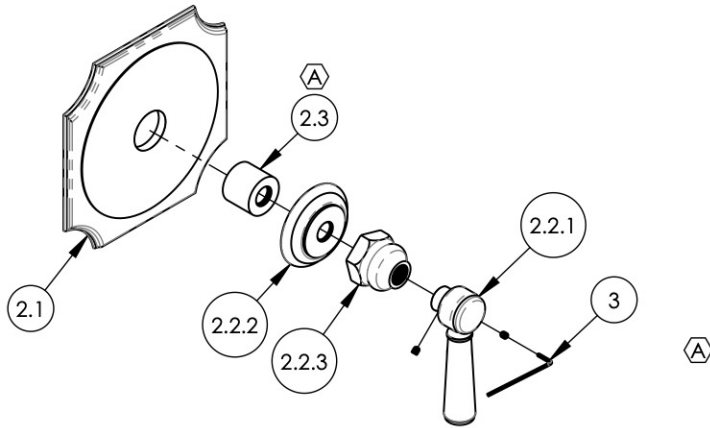
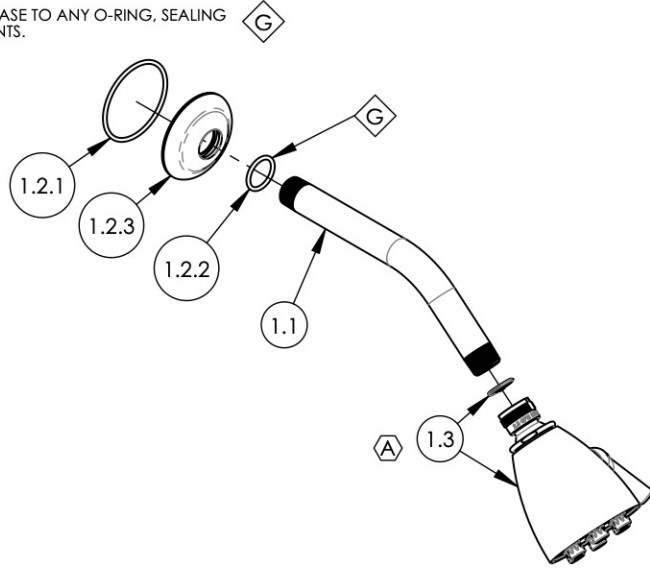

ITEM NO.	PART NUMBER	DESCRIPTION	QTY.
1	4-140/00	SHOWER HEAD 8" ARM, 6 JET PLUNGER, HEX TRADITIONAL	1
1.1	P16008/00	SHOWER ARM (8 INCH)	1
1.2	810/00	SHOWER FLANGE, TRADITIONAL	1
1.2.1	90138	O-RING, 2 1/8"ID X 3/32"THK., AS-568-138	1
1.2.2	90117	O-RING, 7/8"ID X 3/32"THK., AS-568-117	1
1.2.3	P16011/00	K803 SHOWER FLANGE	1
1.3	P16014/00	SHOWERHEAD SIX JET	1
2	4-159/00	1/2" MINI THERMOSTATIC SHOWER TRIM, MARBLE LEVER HANDLES	1
2.1	10515/00	TRIM PLATE, FRENCH TRAD. PB/THERMO	1
2.2	3-373/00	LEVER HANDLE ASSY., WALL/SHOWER, LESS INSERT	1
2.2.1	2-142/00	MARBLE LEVER HANDLE, 500 SERIES, HEX TRADITIONAL	1
2.2.2	10618/00	ESCUTCHEON, TRADITIONAL 500	1
2.2.3	10621/00	BASE HUB NUT	1
2.3	11087	SLEEVE FOR PB-THERM PLATE	1
3	P39001	HEX KEY 5/64, FOR 8-32 SET SCREW	1

ALL	A	UPDATE TEMPLATE, SUBASSYS, & HEX KEY, ADD MARBLE NOTES	4/21/2020	AMM
ZONE	REV.	DESCRIPTION	DATE	APPROVED
REVISIONS				

1261 LOGAN AVENUE
COSTA MESA, CALIFORNIA 92626
PHONE: 714.361.4800
FAX: 714.617.3120

PHYL RICH[®]
Defining Luxury Since 1959

PROPRIETARY AND CONFIDENTIAL
THE INFORMATION CONTAINED IN THIS DRAWING IS THE SOLE PROPERTY OF PHYL RICH. ANY REPRODUCTION IN PART OR AS A WHOLE WITHOUT THE WRITTEN PERMISSION OF PHYL RICH IS PROHIBITED.

-	-	INTERPRET GEOMETRIC DIMENSIONING & TOLERANCING IN ACCORDANCE WITH ASME Y14.5-2009 & ASME Y14.41-2003 STANDARDS, UNLESS OTHERWISE SPECIFIED. DIMENSIONS ARE IN INCHES. TOLERANCES ARE:		
NEXT ASSY	USED ON	FRACTIONS ±1/16"	DECIMALS X.X: ±.1 X.XX: ±.01 X.XXX: ±.005	ANGULAR ±2°
APPLICATION		MATERIAL	NAME	DATE
FINISH		DRAWN	LLO	10/28/2015
DO NOT SCALE DRAWING		CHECKED	GRE	

**PRESSURE BALANCE SHOWER SET,
MARBLE LEVER HANDLES, HENRI SERIES**

SIZE A	ASM/PRT NO. 161-23/00	REV A
SCALE: 1:5	WEIGHT: lbs.	SHEET 1 OF 2