

NOTE(S):

1. APPLY NSF COMPLIANT GREASE TO ANY O-RING, SEALING JOINTS, AND/OR PIVOTAL POINTS. ◇ G
2. APPLY NSF COMPLIANT LOCTITE TO THREADED AREA. ◇ L

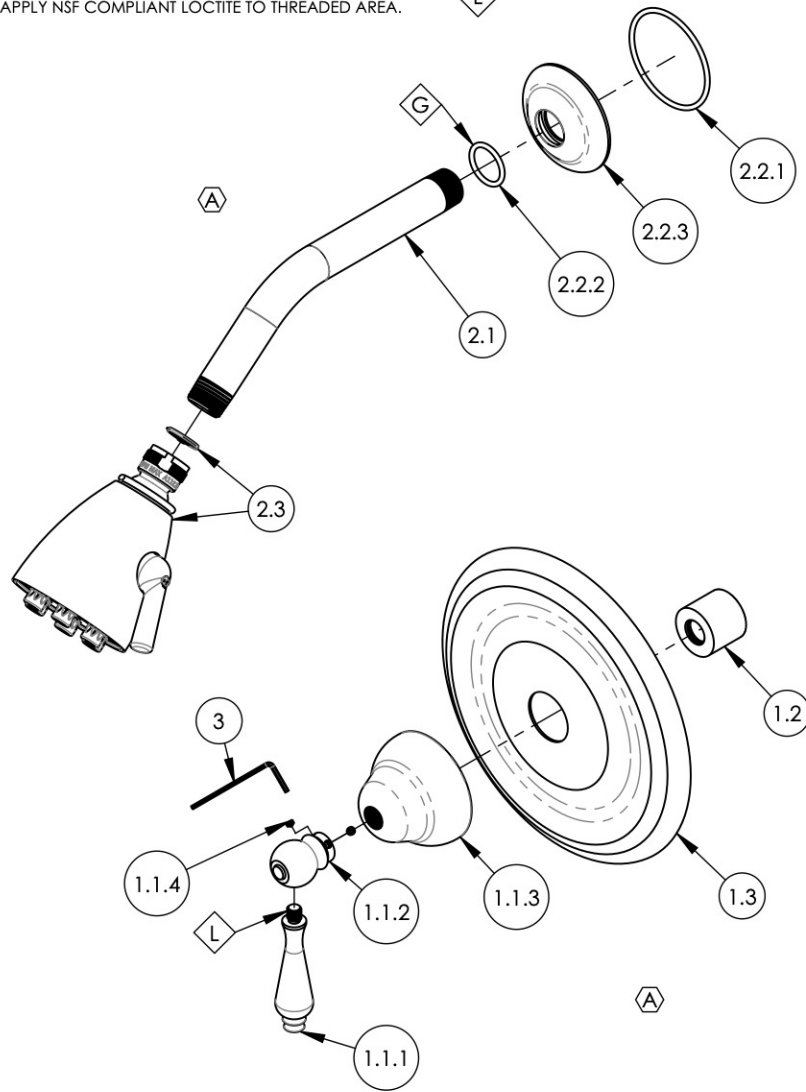

ITEM NO.	PART NUMBER	DESCRIPTION	QTY.
1	4-071/00	PB PLATE, STRAIGHT LEVER, REVERE & SAVANNAH	1
1.1	3-470/00	ASSY. LEVER HANDLE, REVERE & SAVANNAH	1
1.1.1	P01032/00	K160 LEVER FOR HANDLE	1
1.1.2	P01031/00	K160 D100 BALL FOR HANDLE, HUB	1
1.1.3	P02004/00	K190X2 COVER PLATE	1
1.1.4	92163	SET SCREW, CONE PT 8-32 X 1/8"L	2
1.2	11087	SLEEVE FOR PB-THERM PLATE	1
1.3	P17009/00	PRESSURE BALANCE TRIM PLATE	1
2	4-140/00	SHOWER HEAD 8" ARM, 6 JET PLUNGER, HEX TRADITIONAL	1
2.1	P16008/00	SHOWER ARM (8 INCH)	1
2.2	810/00	SHOWER FLANGE, TRADITIONAL	1
2.2.1	90138	O-RING, 2 1/8"ID X 3/32"THK., AS-568-138	1
2.2.2	90117	O-RING, 7/8"ID X 33/32"THK., AS-568-117	1
2.2.3	P16011/00	K803 SHOWER FLANGE	1
2.3	3-018/00	SHOWERHEAD SIX JET	1
3	P39001	HEX KEY 5/64, FOR 8-32 SET SCREW	1

ALL	REV.	DESCRIPTION	DATE	APPROVED
A		UPDATE TEMPLATE, ADD/UPDATE SUBASSYS, REMOVE FOAM/VALVE	6/19/2020	AMM
REVISIONS				

1261 LOGAN AVENUE  
COSTA MESA, CALIFORNIA 92626  
PHONE: 714.361.4800  
FAX: 714.617.3120

**PHYLIRICH**<sup>®</sup>  
Defining Luxury Since 1959

**PROPRIETARY AND CONFIDENTIAL**  
THE INFORMATION CONTAINED IN THIS DRAWING IS THE SOLE PROPERTY OF PHYLIRICH. ANY REPRODUCTION IN PART OR AS A WHOLE WITHOUT THE WRITTEN PERMISSION OF PHYLIRICH IS PROHIBITED.

NEXT ASSY		USED ON		FRACTIONS ±1/16"		DECIMALS X.X: ±.1 X.XX: ±.01 X.XXX: ±.005		ANGULAR ±2°	
APPLICATION		MATERIAL		NAME		DATE		DRAWN	
FINISH		DRAWN		CA		10/11/2013		CHECKED	
<b>DO NOT SCALE DRAWING</b>									

**PB SHOWER SET TRIM, STRAIGHT LEVER, REVERE & SAVANNAH (100-21/00)**

SIZE **A** ASM/PRT NO. **DPB3100/00** REV **A**

SCALE: 1:4 WEIGHT: lbs. SHEET 1 OF 2