

- NOTE(S):
1. PART NUMBER, "/00" DENOTES PART SHALL HAVE FINISH.
 2. APPLY NSF COMPLIANT GREASE TO ANY O-RING, SEALING JOINTS, AND/OR PIVOTAL POINTS.
 3. APPLY NSF COMPLIANT LOCTITE TO THREADED AREA.
 4. APPLY NSF COMPLIANT REMOVABLE (BLUE) LOCTITE TO THREADED AREA.
 5. SILVER SOLDER JOINTS SHALL BE FULLY WETTED VIA CAPILLARY ACTION AND COMPLETELY NON-POROUS.

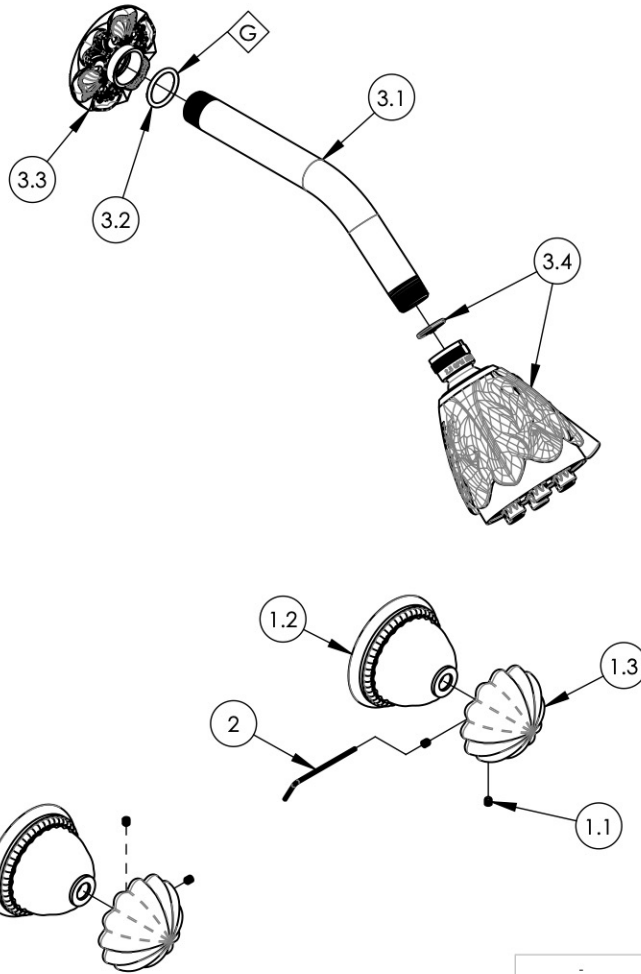

ITEM NO.	PART NUMBER	DESCRIPTION	QTY.
1	3-226/00	ROUND HANDLE, GEORGIAN & BARCELONA	2
1.1	92008	SET SCREW, CUP POINT 8-32, 3/16" L.	2
1.2	P02013/00	K141 COVER PLATE	1
1.3	P01015/00	K110 HANDLE	1
2	92021	HEX KEY 5/64, FOR 8-32 SET SCREW	1
3	K807/00	SHOWER HEAD, EMPIRE	1
3.1	P16008/00	SHOWER ARM (8 INCH)	1
3.2	90117	O-RING, 7/8"ID X 33/32"THK., AS-568-117	1
3.3	P16003/00	K804 FLANGE	1
3.4	3-579/00	ASSY, SHOWER JET, OVERLAY, EMPIRE	1

ZONE	REV.	DESCRIPTION	DATE	APPROVED
REVISIONS				

1261 LOGAN AVENUE
COSTA MESA, CALIFORNIA 92626
PHONE: 714.361.4800
FAX: 714.617.3120

PHYLIRICH[®]
Defining Luxury Since 1959

PROPRIETARY AND CONFIDENTIAL
THE INFORMATION CONTAINED IN THIS DRAWING IS THE SOLE PROPERTY OF PHYLIRICH. ANY REPRODUCTION IN PART OR AS A WHOLE WITHOUT THE WRITTEN PERMISSION OF PHYLIRICH IS PROHIBITED.

-	-	INTERPRET GEOMETRIC DIMENSIONING & TOLERANCING IN ACCORDANCE WITH ASME Y14.5-2009 & ASME Y14.41-2003 STANDARDS, UNLESS OTHERWISE SPECIFIED. DIMENSIONS ARE IN INCHES. TOLERANCES ARE:		
NEXT ASSY	USED ON	FRACTIONS ±1/16"	DECIMALS X.X: ±.1 X.XX: ±.01 X.XXX: ±.005	ANGULAR ±2°
APPLICATION		NAME	DATE	
MATERIAL		DRAWN	AMM	12/21/2020
FINISH		CHECKED	AMM	12/21/2020
DO NOT SCALE DRAWING				

TWO HANDLE SHOWER SET, ROUND, GEORGIAN & BARCELONA

SIZE	ASM/PRT NO.	REV
A	K3361/00	
SCALE: 1:4.5	WEIGHT: lbs.	SHEET 1 OF 2