

- NOTE(S):
 1. APPLY NSF COMPLIANT GREASE TO ANY O-RING, SEALING JOINTS, AND/OR PIVOTAL POINTS.
 2. APPLY NSF COMPLIANT LOCTITE TO THREADED AREA. 

A

B

C

D

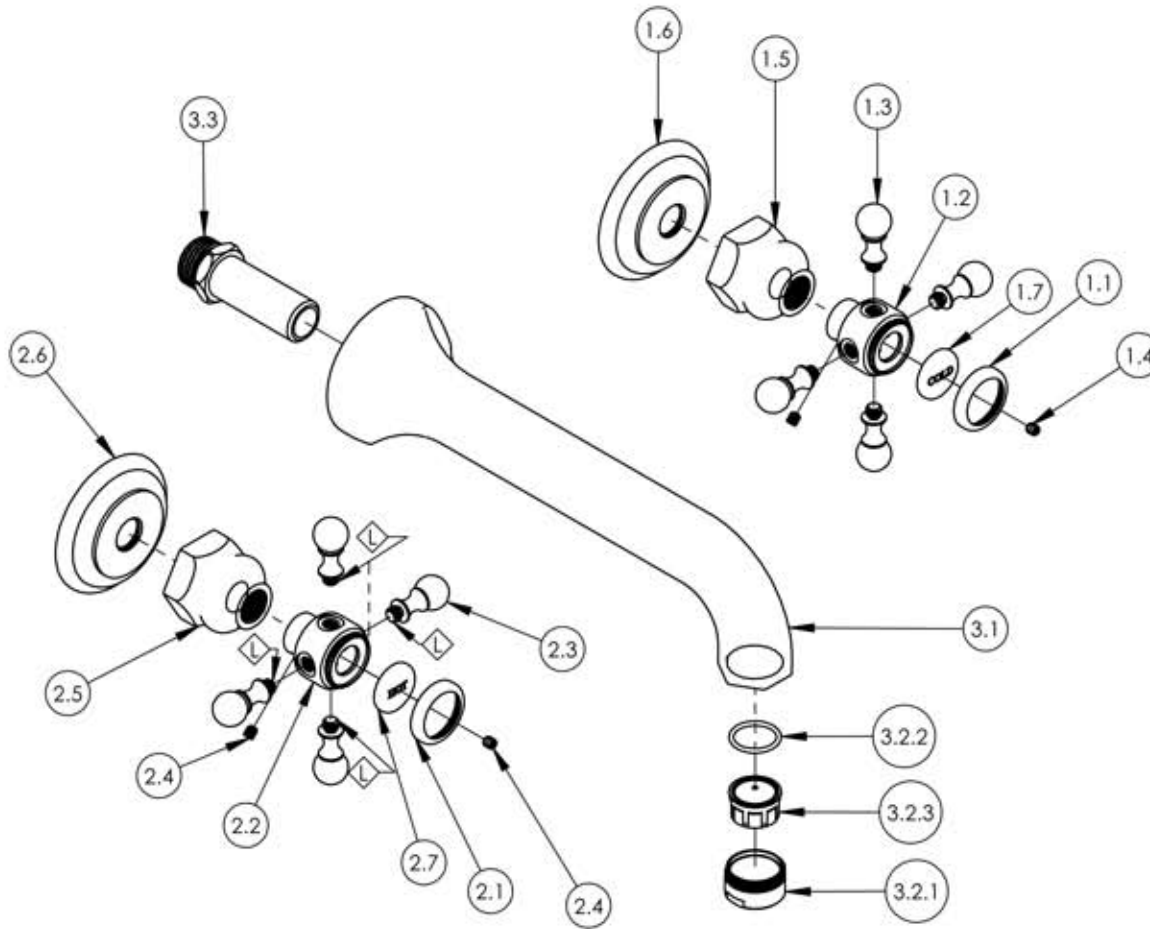

ITEM NO.	PART NUMBER	DESCRIPTION	QTY.
1	3-142C/00	CROSS HANDLE, WALL/SHOWER, 500 SERIES	1
1.1	10538/00	CAP RING FOR 500 SERIES BUTTON	1
1.2	10622/00	HUB FOR HANDLE, CROSS	1
1.3	10623/00	HANDLE FINIAL CROSS	4
1.4	92008	SET SCREW, CUP POINT 8-32	2
1.5	10621/00	BASE HUB NUT	1
1.6	10618/00	ESCUTCHEON, TRADITIONAL 500	1
1.7	11098	PLASTIC BUTTON, COLD	1
2	3-142H/00	CROSS HANDLE, WALL/SHOWER, 500 SERIES	1
2.1	10538/00	CAP RING FOR 500 SERIES BUTTON	1
2.2	10622/00	HUB FOR HANDLE, CROSS	1
2.3	10623/00	HANDLE FINIAL CROSS	4
2.4	92008	SET SCREW, CUP POINT 8-32	2
2.5	10621/00	BASE HUB NUT	1
2.6	10618/00	ESCUTCHEON, TRADITIONAL 500	1
2.7	11099	PLASTIC BUTTON, HOT	1
3	3-147	SPOUT, WALL TUB, 500/501 SERIES	1
3.1	10427/00	SPOUT WALL, HEX	1
3.2	3-409/00	AERATOR, 15/16" MALE HOUSING FULL FLOW	1
3.2.1	10784/00	HOUSING, AERATOR 15/16"-27	1
3.2.2	90017	O-RING, 11/16"ID X 13/16"OD X 1/16"THK, AS-568-017	1
3.2.3	30031	AERATOR, FULL FLOW 15/16-27	1
3.3	10432	NIPPLE, WALL SPOUT	1
3.4	92010	SET SCREW, CUP POINT 8-32UNC 5/16" LENGTH SS	1

E

ZONE	REV.	DESCRIPTION	DATE	APPROVED
------	------	-------------	------	----------

REVISIONS

1261 LOGAN AVENUE
 COSTA MESA, CALIFORNIA 92626
 PHONE: 714.361.4800
 FAX: 714.617.3120

PHYLORICH®

Defining Luxury Since 1959

PROPRIETARY AND CONFIDENTIAL
 THE INFORMATION CONTAINED IN THIS DRAWING IS THE SOLE PROPERTY OF R3S MANUFACTURING. ANY REPRODUCTION IN PART OR AS A WHOLE WITHOUT THE WRITTEN PERMISSION OF R3S MANUFACTURING IS PROHIBITED.

-	-	INTERPRET GEOMETRIC DIMENSIONING & TOLERANCING IN ACCORDANCE WITH ASME Y14.5-2009 & ASME Y14.41-2003 STANDARDS, UNLESS OTHERWISE SPECIFIED. DIMENSIONS ARE IN INCHES. TOLERANCES ARE:
NEXT ASSY	USED ON	FRACTIONS ±1/64" DECIMALS X.X: ±.1 X.XX: ±.01 X.XXX: ±.005 ANGULAR ±.5°
MATERIAL	APPLICATION	NAME DATE
FINISH	DRAWN	LLO 9/9/2015
DO NOT SCALE DRAWING	CHECKED	GRE

WALL TUB SET TRIM, CROSS HDLS HEX TRAD.

SIZE **A** ASM/PRT NO. **500-56/00** REV **-**

SCALE: 1:3 WEIGHT: lbs. SHEET 1 OF 2