

NOTE(S):
 1. APPLY NSF COMPLIANT GREASE TO ANY O-RING, SEALING JOINTS, AND/OR PIVOTAL POINTS.

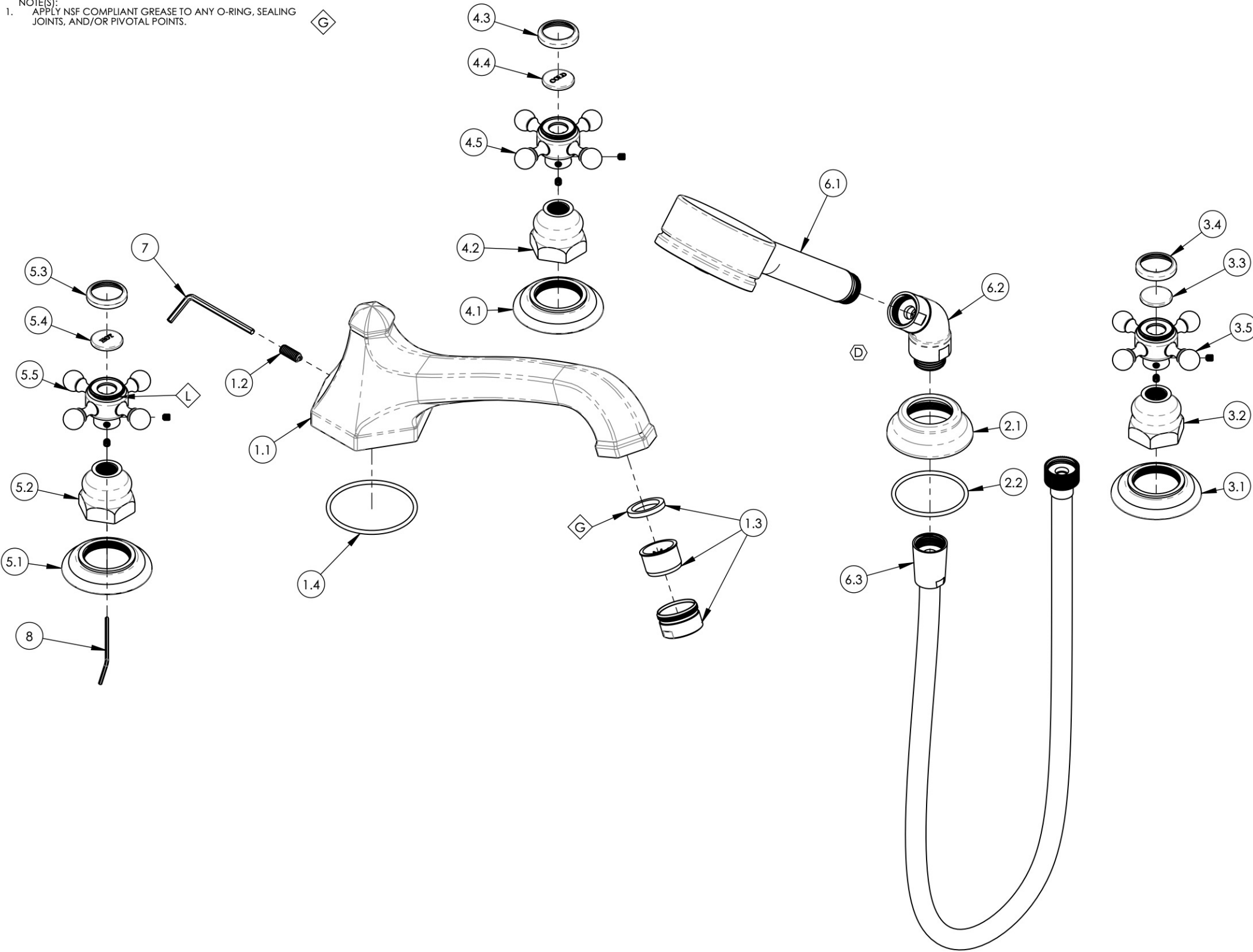

ITEM NO.	PART NUMBER	DESCRIPTION	QTY.
1	3-144/00	SPOUT, DECK TUB, 500/501 SERIES	1
1.1	P27015	SPOUT, DECK TUB, LE VERRE LA CROSSE	1
1.2	92262	SET SCREW, CUP PT 1/4"-20 X 5/8"L	1
1.3	3-610/00	AERATOR & HOUSING, M28X1, TUB FILLER, FULL FLOW	1
1.4	90139	O-RING, 2-3/16ID X 3/32THK., AS-568-139	1
2	3-210/00	ESCUTCHEON BASE, HANDSHOWER, TRADITIONAL	1
2.1	P18001/00	ESCUTCHEON BASE, DECK TUB, HANDSHOWER, TRADITIONAL	1
2.2	90133	1 3/4"O-RING, 1-13/16ID X 3/32THK, AS-568-133	1
3	3-382B/00	CROSS HANDLE ASSEMBLY, DECK TUB (BLANK)	1
3.1	10620/00	ESCUTCHEON, TRADITIONAL RT 1-1/4"-20	1
3.2	10621/00	BASE HUB NUT	1
3.3	11097	PLASTIC BUTTON, BLANK	1
3.4	10538/00	CAP RING FOR 500 SERIES BUTTON	1
3.5	2-180/00	SUB ASSY. CROSS HANDLE HUB	1
4	3-382C/00	CROSS HANDLE, DECK TUB (COLD)	1
4.1	10620/00	ESCUTCHEON, TRADITIONAL RT 1-1/4"-20	1
4.2	10621/00	BASE HUB NUT	1
4.3	10538/00	CAP RING FOR 500 SERIES BUTTON	1
4.4	11098	PLASTIC BUTTON, COLD	1
4.5	2-180/00	SUB ASSY. CROSS HANDLE HUB	1
5	3-382H/00	CROSS HANDLE ASSEMBLY, DECK TUB (HOT)	1
5.1	10620/00	ESCUTCHEON, TRADITIONAL RT 1-1/4"-20	1
5.2	10621/00	BASE HUB NUT	1
5.3	10538/00	CAP RING FOR 500 SERIES BUTTON	1
5.4	11099	PLASTIC BUTTON, HOT	1
5.5	2-180/00	SUB ASSY. CROSS HANDLE HUB	1
6	4-524/00	HAND SHOWER HEAD, ELBOW, HOSE, SINGLE FUNCTION STILO 70	1
6.1	3-066/00	HANDSHOWER, SINGLE FUNCTION STILO 70	1
6.2	3-050/00	ELBOW ASSEMBLY	1
6.3	3-049/00	ASSY. HOSE KIT, HANDSHOWER	1
7	92216	HEX L-KEY 1/8" HEX x 2-5/16"L	1
8	P39001	HEX KEY 5/64, FOR 8-32 SET SCREW	1

D4	D	UPDATE HAND SHOWER ASSEMBLY	10/8/2020	AMM
ZONE	REV.	DESCRIPTION	DATE	APPROVED
REVISIONS				
1261 LOGAN AVENUE COSTA MESA, CALIFORNIA 92626 PHONE: 714.361.4800 FAX: 714.617.3120		PHYLIRICH Defining Luxury Since 1959		PROPRIETARY AND CONFIDENTIAL THE INFORMATION CONTAINED IN THIS DRAWING IS THE SOLE PROPERTY OF PHYLIRICH. ANY REPRODUCTION IN PART OR AS A WHOLE WITHOUT THE WRITTEN PERMISSION OF PHYLIRICH IS PROHIBITED.

-	-	INTERPRET GEOMETRIC DIMENSIONING & TOLERANCING IN ACCORDANCE WITH ASME Y14.5-2009 & ASME Y14.41-2003 STANDARDS. UNLESS OTHERWISE SPECIFIED, DIMENSIONS ARE IN INCHES. TOLERANCES ARE: FRACTIONS ±1/16" DECIMALS X.X: ±.1 X.XX: ±.01 X.XXX: ±.005 ANGULAR ±2°	
NEXT ASSY	USED ON		
APPLICATION			
MATERIAL			
FINISH	DRAWN	LLO	9/8/2015
DO NOT SCALE DRAWING	CHECKED	GRE	

DECK TUB SET W/ HANDSHOWER, CROSS, HEX TRADITIONAL		
SIZE	ASM/PRT NO.	REV
B	500-48/00	D
SCALE: 1:3	WEIGHT: lbs.	SHEET 1 OF 2