

- NOTE(S):
1. APPLY NSF COMPLIANT GREASE TO ANY O-RING, SEALING JOINTS, AND/OR PIVOTAL POINTS. G
 2. APPLY NSF COMPLIANT LOCTITE TO THREADED AREA. L

ITEM NO.	PART NUMBER	DESCRIPTION	QTY.
1	3-394/00	ASSY, HIGH ARC TUB SPOUT, DECK TUB BASIC II	1
1.1	2-128/00	SUB ASSY, HIGH ARC TUB SPOUT, DECK TUB BASIC II	1
1.2	11186/00	BASE FLANGE, BASIC II	1
1.3	90033	O-RING, 2"ID X 2-1/8"OD X 1/16"THK, AS-568-033	1
1.4	P05024	AERATOR CACHE COIN SLOT, M21.5X1.0 FULL FLOW	1
1.5	92127	SET SCREW, CUP PT, 1/4"-20 X 5/16" L, SS	1
2	3-435/00	ASSEMBLY LEVER HANDLE, DECK TUB, BASIC II	2
2.1	92008	SET SCREW, CUP POINT 8-32, 3/16" L.	2
2.2	90032	O-RING, 1-7/8"ID X 2"OD X 1/16"THK, AS-568-032	1
2.3	11344/00	ESCUTCHEON BASE, DECK TUB HANDLE, BASIC II	1
2.4	11167/00	BASE HANDLE, CONTEMP. BASIC II	1
2.5	11168/00	HANDLE LEVER, CONTEMP. BASIC II	1

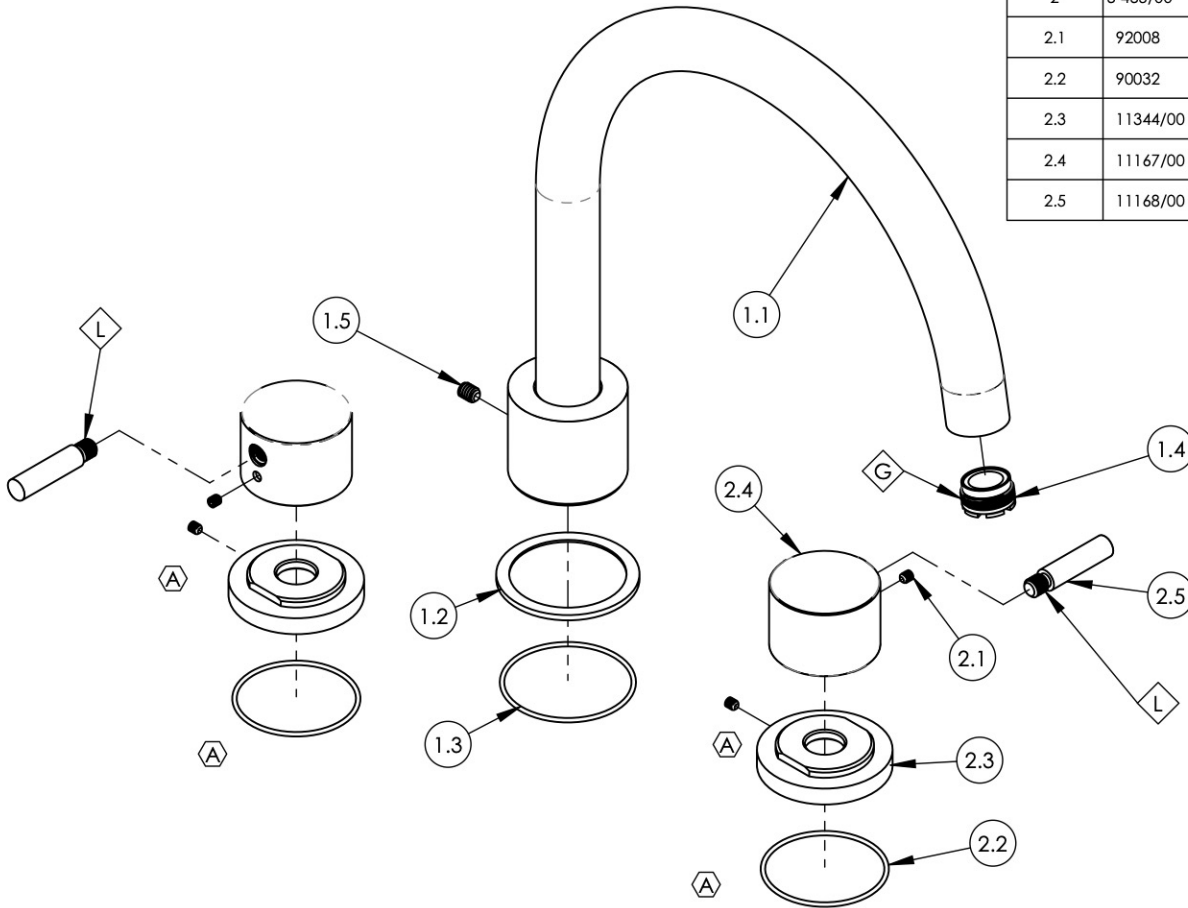

ALL	REV.	DESCRIPTION	DATE	APPROVED
A		UPDATE TEMPLATE, REMOVE SLEEVE MOUNTS, ADD CALL OUTS, ORIENT HANDLE SET SCREWS	4/3/2020	AMM

REVISIONS

1261 LOGAN AVENUE
COSTA MESA, CALIFORNIA 92626

PHONE: 714.361.4800
FAX: 714.617.3120

PHYLIRICH®

Defining Luxury Since 1959

PROPRIETARY AND CONFIDENTIAL

THE INFORMATION CONTAINED IN THIS DRAWING IS THE SOLE PROPERTY OF PHYLIRICH. ANY REPRODUCTION IN PART OR AS A WHOLE WITHOUT THE WRITTEN PERMISSION OF PHYLIRICH IS PROHIBITED.

INTERPRET GEOMETRIC DIMENSIONING & TOLERANCING IN ACCORDANCE WITH ASME Y14.5-2009 & ASME Y14.41-2003 STANDARDS, UNLESS OTHERWISE SPECIFIED. DIMENSIONS ARE IN INCHES. TOLERANCES ARE:	FRACTIONS ±1/16"	DECIMALS X.X: ±.1 X.XX: ±.01 X.XXX: ±.005	ANGULAR ±2°
NEXT ASSY	USED ON	APPLICATION	
MATERIAL	NAME	DATE	
FINISH	DRAWN	FME	11/5/2015
DO NOT SCALE DRAWING	CHECKED	LLO	

DECK TUB SET, LEVER HANDLES, BASIC II SERIES

SIZE	ASM/PRT NO.	REV
A	230-43/00	A

SCALE: 1:3 WEIGHT: lbs. SHEET 1 OF 2