

- NOTE(S):
- EXAMPLE OF SPLIT FINISH CODE:  
A. 230-03/026X030
  - MARBLE HANDLE STONE OPTIONS:  
A. BLACK MARBLE = 3-570 (.../00X030)  
B. WHITE MARBLE = 3-571 (.../00X031)  
C. SOAPSTONE = 3-572 (.../00X032)
  - APPLY NSF COMPLIANT GREASE TO ANY O-RING, SEALING JOINTS, AND/OR PIVOTAL POINTS. G

ITEM NO.	PART NUMBER	DESCRIPTION	QTY.
1	3-394/00	ASSY, HIGH ARC TUB SPOUT, DECK TUB BASIC II	1
1.1	2-128/00	SUB ASSY, HIGH ARC TUB SPOUT, DECK TUB BASIC II	1
1.2	11186/00	BASE FLANGE, BASIC II	1
1.3	90033	O-RING, 2"ID X 2-1/8"OD X 1/16"THK, AS-568-033	1
1.4	P05024	AERATOR CACHE COIN SLOT, M21.5X1.0 FULL FLOW	1
1.5	92127	SET SCREW, CUP PT, 1/4"-20 X 5/16"L, SS	1
2	3-570	HANDLE, ROUND MARBLE, BLACK (030) ASSY	2
3	11344/00	ESCUTCHEON BASE, DECK TUB HANDLE, BASIC II	2
4	90032	O-RING, 1-7/8"ID X 2"OD X 1/16"THK, AS-568-032	2
5	92008	SET SCREW, CUP POINT 8-32, 3/16" L.	2

SEE NOTES \*

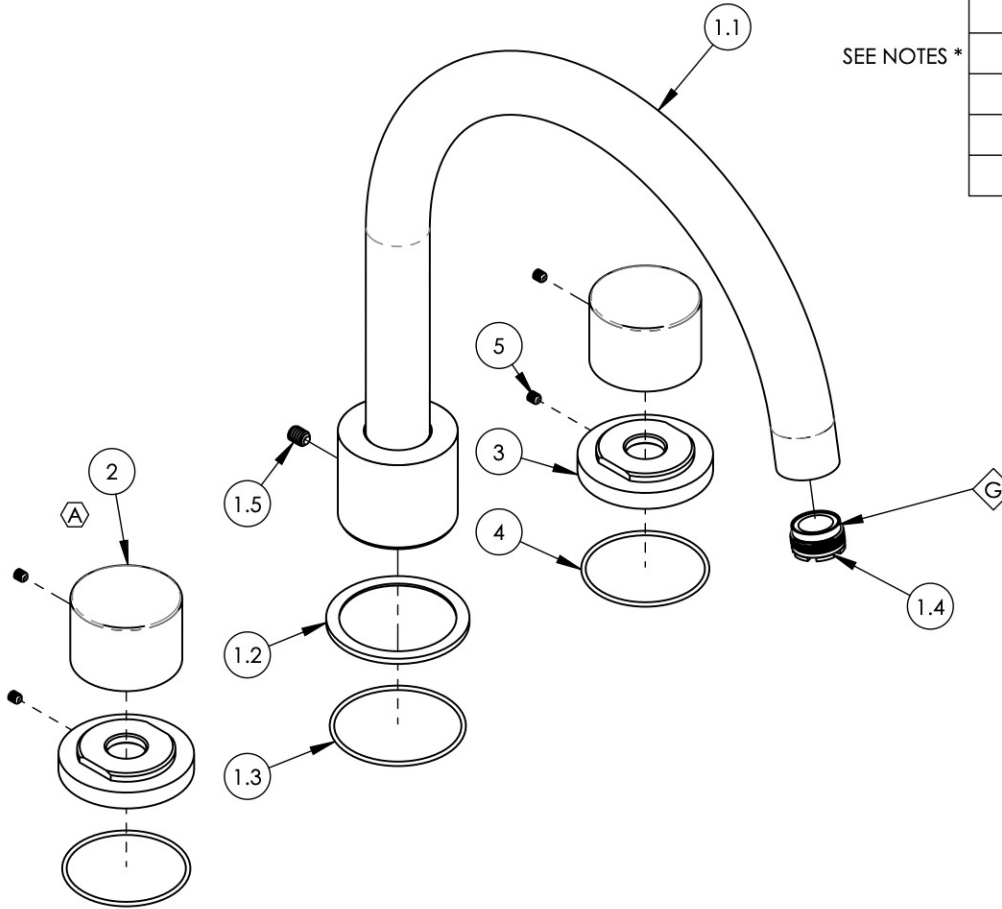

ZONE	REV.	DESCRIPTION	DATE	APPROVED
C5	A	REMOVE INTERNAL SUBASSY FROM HANDLE	11/3/2020	AMM
REVISIONS				

1261 LOGAN AVENUE  
COSTA MESA, CALIFORNIA 92626  
PHONE: 714.361.4800  
FAX: 714.617.3120

**PHYL RICH**<sup>®</sup>  
Defining Luxury Since 1959

**PROPRIETARY AND CONFIDENTIAL**  
THE INFORMATION CONTAINED IN THIS DRAWING IS THE SOLE PROPERTY OF PHYL RICH. ANY REPRODUCTION IN PART OR AS A WHOLE WITHOUT THE WRITTEN PERMISSION OF PHYL RICH IS PROHIBITED.

INTERPRET GEOMETRIC DIMENSIONING & TOLERANCING IN ACCORDANCE WITH ASME Y14.5-2009 & ASME Y14.41-2003 STANDARDS, UNLESS OTHERWISE SPECIFIED. DIMENSIONS ARE IN INCHES. TOLERANCES ARE:	FRACTIONS ±1/16"	DECIMALS X.X: ±.1 X.XX: ±.01 X.XXX: ±.005	ANGULAR ±2°
APPLICATION			
MATERIAL		NAME	DATE
FINISH	DRAWN	AMM	4/30/2020
<b>DO NOT SCALE DRAWING</b>	CHECKED		

**DECK TUB SET, MARBLE HANDLES, BASIC II SERIES**

SIZE	ASM/PRT NO.	REV
<b>A</b>	230-42/00	A
SCALE: 1:3	WEIGHT: lbs.	SHEET 1 OF 2