

NOTE(S):
 1. APPLY NSF COMPLIANT GREASE TO ANY O-RING, SEALING JOINTS, AND/OR PIVOTAL POINTS.

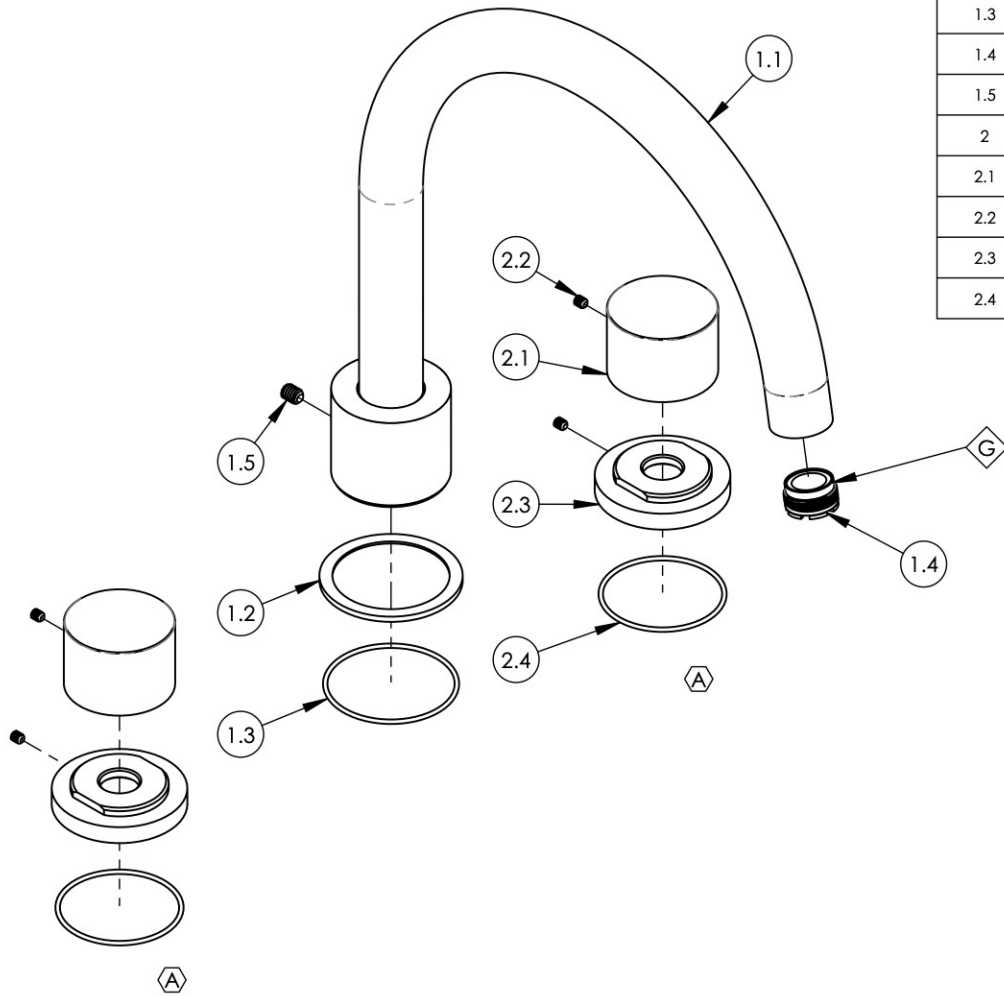

ITEM NO.	PART NUMBER	DESCRIPTION	QTY.
1	3-394/00	ASSY, HIGH ARC TUB SPOUT, DECK TUB BASIC II	1
1.1	2-128/00	SUB ASSY, HIGH ARC TUB SPOUT, DECK TUB BASIC II	1
1.2	11186/00	BASE FLANGE, BASIC II	1
1.3	90033	O-RING, 2"ID X 2-1/8"OD X 1/16"THK, AS-568-033	1
1.4	P05024	AERATOR CACHE COIN SLOT, M21.5X1.0 FULL FLOW	1
1.5	92127	SET SCREW, CUP POINT, 1/4-20 X 5/16"L, STAINLESS STEEL	1
2	3-434/00	ASSEMBLY SMOOTH HANDLE, DECK TUB, BASIC II	2
2.1	10433/00	BASE HANDLE, CONTEMP. BASIC II	1
2.2	92008	SET SCREW, CUP POINT 8-32, 3/16" L.	2
2.3	11344/00	ESCUTCHEON BASE, DECK TUB HANDLE, BASIC II	1
2.4	90032	O-RING, 1-7/8"ID X 2"OD X 1/16"THK, AS-568-032	1

ALL	REV.	DESCRIPTION	DATE	APPROVED
A		REMOVE SLEEVE MOUNTS, UPDATE TEMPLATE, ADD CALL OUTS	4/3/2020	AMM
REVISIONS				

1261 LOGAN AVENUE
 COSTA MESA, CALIFORNIA 92626
 PHONE: 714.361.4800
 FAX: 714.617.3120

PHYLIRICH[®]
 Defining Luxury Since 1959

PROPRIETARY AND CONFIDENTIAL
 THE INFORMATION CONTAINED IN THIS DRAWING IS THE SOLE PROPERTY OF PHYLIRICH. ANY REPRODUCTION IN PART OR AS A WHOLE WITHOUT THE WRITTEN PERMISSION OF PHYLIRICH IS PROHIBITED.

NEXT ASSY		USED ON		INTERPRET GEOMETRIC DIMENSIONING & TOLERANCING IN ACCORDANCE WITH ASME Y14.5-2009 & ASME Y14.41-2003 STANDARDS, UNLESS OTHERWISE SPECIFIED. DIMENSIONS ARE IN INCHES. TOLERANCES ARE:		
APPLICATION		FRACTIONS ±1/16"	DECIMALS X.X: ±.1 X.XX: ±.01 X.XXX: ±.005	ANGULAR ±2°		
MATERIAL	NAME		DATE			
FINISH	DRAWN	FME	11/5/2015			
DO NOT SCALE DRAWING			CHECKED	LLO		

DECK TUB SET, SMOOTH HANDLES, BASIC II SERIES

SIZE	ASM/PRT NO.	REV
A	230-41/00	A
SCALE: 1:3	WEIGHT: lbs.	SHEET 1 OF 2