

A

B

C

D

E

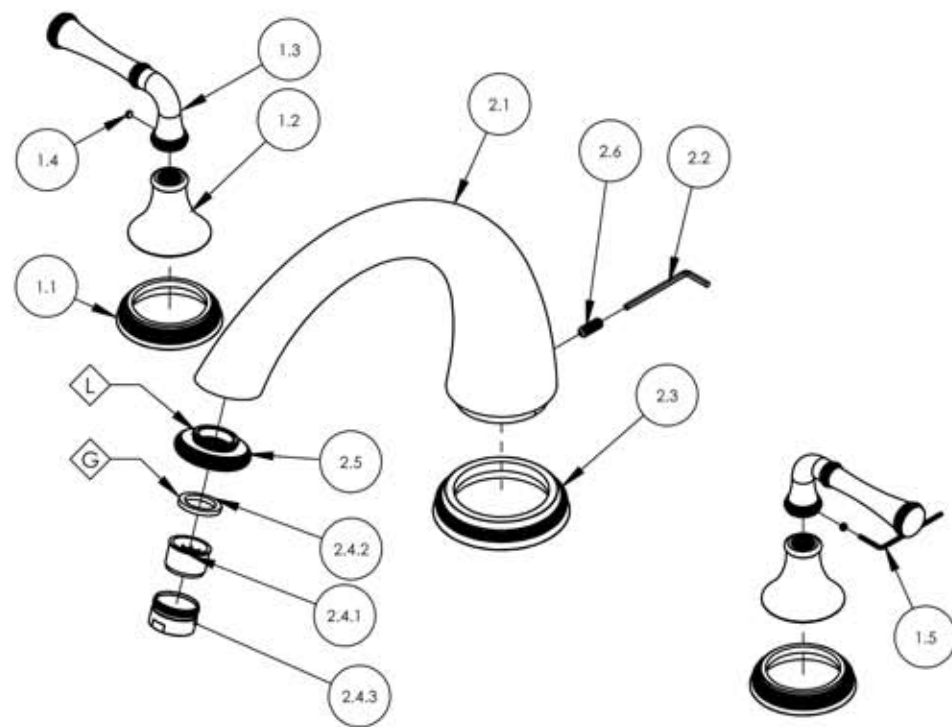

ITEM NO.	PART NUMBER	DESCRIPTION	QTY.
1	3-317/00	LEVER HANDLE, COINED SERIES	2
1.1	10978/00	ESCUTCHEON HANDLE BASE COINED, 3RING, COINED SERIES	1
1.2	10972/00	HUB, TRANSITIONAL 3RING	1
1.3	10977/00	HANDLE, STRAIGHT LEVER COINED, 3RING	1
1.4	92163	SET SCREW, CONE PT 8-32 X 1/8"L	1
1.5	P39001	HEX KEY 5/64, FOR 8-32 SET SCREW	1
2	3-320/00	DECK TUB SPOUT, P27020 SPOUT, COINED SERIES	1
2.1	P27020/00	K5120 DECK SPOUT	1
2.2	P39005	3MM HEX KEY	1
2.3	11120/00	ESCUTCHEON, COINED DECK SPOUT	1
2.4	P05003	AERATOR & HOUSING, M28	1
2.4.1	P05003_2	AERATOR INSERT NEOSTRAHL	1
2.4.2	P05003_3	RUBBER WASHER, 3/4"ID X 1"OD X 1/8"THK. 55.1252.1	1
2.4.3	10583/00	AERATOR HOUSING, M28 41.2007.000	1
2.5	11117/00	RING HOUSING AERATOR M28X1, COINED 3RING	1
2.6	92202	SET SCREW M6X1.0 X 16MM	1

NOTE(S):
 1. ALL DIMENSIONS SHOWN ARE FOR REFERENCE ONLY

- APPLY NSF COMPLAINT GREASE TO ANY O-RING AND/OR SEALING JOINTS. G
- APPLY NSF COMPLAINT LOCTITE TO THREADED AREA. L

ALL	A	UPDATED DRAWING	10/23/2015	GRE	INTERPRET GEOMETRIC DIMENSIONING & TOLERANCING IN ACCORDANCE WITH ASME Y14.5-2009 & ASME Y14.41-2003 STANDARDS. UNLESS OTHERWISE SPECIFIED, DIMENSIONS ARE IN INCHES. TOLERANCES ARE:				DECK TUB SET, COINED SERIES				
ZONE	REV.	DESCRIPTION	DATE		NEXT ASSY	USED ON	FRACTIONS 1/64"	DECIMALS X.X: .1 X.XX: .01 X.XXX: .005	ANGULAR .5	SIZE A	ASM/PRT NO. 208-40/00	REV A	
REVISIONS					MATERIAL	APPLICATION		NAME	DATE	SCALE: 1:4.5 WEIGHT: lbs. SHEET 1 OF 2			
1261 LOGAN AVENUE COSTA MESA, CALIFORNIA 92626 PHONE: 714.361.4800 FAX: 714.617.3120					PHYLORICH® Defining Luxury Since 1959			PROPRIETARY AND CONFIDENTIAL THE INFORMATION CONTAINED IN THIS DRAWING IS THE SOLE PROPERTY OF RSS MANUFACTURING. ANY REPRODUCTION IN PART OR AS A WHOLE WITHOUT THE WRITTEN PERMISSION OF RSS MANUFACTURING IS PROHIBITED.			DO NOT SCALE DRAWING		

5

4

3

2

1