

- NOTE(S):
1. APPLY NSF COMPLIANT GREASE TO ANY O-RING, SEALING JOINTS, AND/OR PIVOTAL POINTS. ◇ G
  2. APPLY NSF COMPLIANT LOCTITE TO THREADED AREA. ◇ L

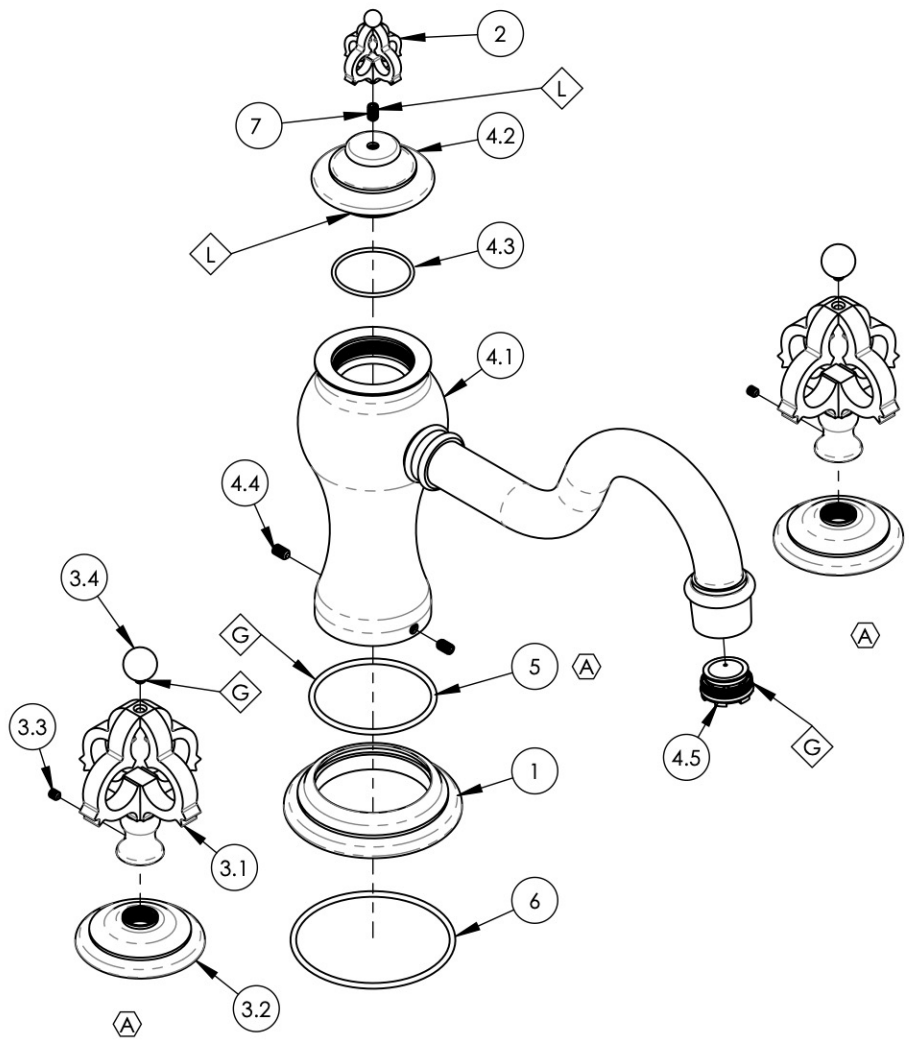

ITEM NO.	PART NUMBER	DESCRIPTION	QTY.
1	11306/00	ESCUTCHEON, DECK TUB, COURONNE	1
2	2-039/00	ASSY, POP-UP COURONNE SERIES	1
3	3-340/00	ASSY, HANDLE & ESCUTCHEON COURONNE SERIES	2
3.1	2-038/00	ASSY, HANDLE & ESCUTCHEON COURONNE SERIES	1
3.2	11175/00	ESCUTCHEON, COURONNE SERIES	1
3.3	92008	SET SCREW, CUP POINT 8-32, 3/16" L.	1
3.4	11160/00	FINIAL BALL, TOP CROWN	1
4	3-397/00	SUB ASSY, SPOUT, DECK TUB, COURONNE/MARVELLE SERIES	1
4.1	2-155/00	SUB ASSY. BRAZED BODY AND SPOUT, COURONNE/MARVELLE SERIES	1
4.2	11305/00	SPOUT CAP, DECK TUB	1
4.3	90028	O-RING, 1-3/8"ID X 1/16"THK, AS-568-028	1
4.4	92060	SET SCREW, 10-24 5/16"L	2
4.5	P05051	AERATOR, CACHE COINED SLOT M24X1.0 FULL FLOW	1
5	90138	O-RING, 2 1/8"ID X 3/32"THK., AS-568-138	1
6	90149	O-RING, 2-13/16" ID X 3/32" THK, AS-568-149	1
7	92060	SET SCREW, 10-24 5/16"L	1

ALL	A	NEW TEMPLATE. UPDATE O-RING ON SPOUT, REMOVE SLEEVE MOUNTS	2/25/2020	AMM
ZONE	REV.	DESCRIPTION	DATE	APPROVED
REVISIONS				

1261 LOGAN AVENUE  
COSTA MESA, CALIFORNIA 92626  
PHONE: 714.361.4800  
FAX: 714.617.3120

**PHYLIRICH**<sup>®</sup>  
Defining Luxury Since 1959

**PROPRIETARY AND CONFIDENTIAL**  
THE INFORMATION CONTAINED IN THIS DRAWING IS THE SOLE PROPERTY OF PHYLIRICH. ANY REPRODUCTION IN PART OR AS A WHOLE WITHOUT THE WRITTEN PERMISSION OF PHYLIRICH IS PROHIBITED.

-	-	INTERPRET GEOMETRIC DIMENSIONING & TOLERANCING IN ACCORDANCE WITH ASME Y14.5-2009 & ASME Y14.41-2003 STANDARDS, UNLESS OTHERWISE SPECIFIED. DIMENSIONS ARE IN INCHES. TOLERANCES ARE:		
NEXT ASSY	USED ON	<b>FRACTIONS</b> ±1/16"	<b>DECIMALS</b> X.X: ±.1 X.XX: ±.01 X.XXX: ±.005	<b>ANGULAR</b> ±2°
APPLICATION		MATERIAL	NAME	DATE
FINISH		DRAWN	LLO	10/21/2015
<b>DO NOT SCALE DRAWING</b>		CHECKED	GRE	

**DECK TUB SET, COURONNE SERIES**

SIZE	ASM/PRT NO.	REV
<b>A</b>	163-40/00	<b>A</b>
SCALE: 1:3.5	WEIGHT: lbs.	SHEET 1 OF 2