

5

4

3

2

1

NOTE(S):

1. EXAMPLE OF SPLIT FINISH CODE:
A. 3-373/026X030

2. SPLIT FINISH CODES:

- A. BLACK MARBLE = 3-373/00X030
- B. WHITE MARBLE = 3-373/00X031
- C. SOAPSTONE = 3-373/00X032

3. AVAILABLE HANDLE STONE PART # OPTIONS:

- A. BLACK MARBLE = 11328 (030)
- B. WHITE MARBLE = 11329 (031)
- C. SOAPSTONE = 11330 (032)

4. APPLY NSF COMPLIANT GREASE TO ANY O-RING, SEALING JOINTS, AND/OR PIVOTAL POINTS.



ITEM NO.	PART NUMBER	DESCRIPTION	QTY.
1	3-373/00	MARBLE LEVER HANDLE ASSY., WALL/SHOWER	2
1.1	2-142/00	MARBLE LEVER HANDLE, 500 SERIES, HEX TRADITIONAL	1
1.2	10618/00	ESCUTCHEON, TRADITIONAL 500	1
1.3	10621/00	BASE HUB NUT	1
2	3-390/00	WALL SPOUT, HENRI SERIES	1
2.1	11158/00	FLANGE, WALL TUB	1
2.2	90118	O-RING, 7/8"ID X 1-1/16"OD X 3/32"THK., AS-568-118	1
2.3	90137	O-RING, 2-1/16"ID X 3/32"THK., AS-568-137	1
2.4	2-108/00	SUB. ASSY, WALL SPOUT	1
3	P05024	AERATOR CACHE COIN SLOT, M21.5X1.0 FULL FLOW	1

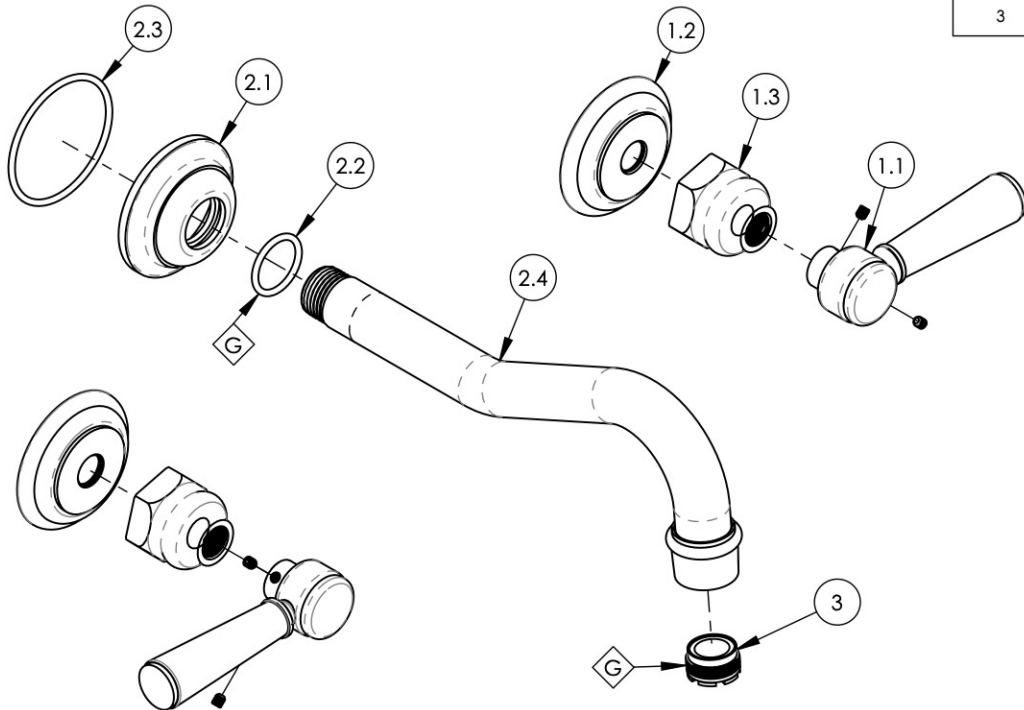

ALL	B	UPDATE TEMPLATE, ADD CALL OUTS & MARBLE NOTES	4/23/2020	AMM
ZONE	REV.	DESCRIPTION	DATE	APPROVED
REVISIONS				

1261 LOGAN AVENUE
COSTA MESA, CALIFORNIA 92626
PHONE: 714.361.4800
FAX: 714.617.3120

PHYLIRICH[®]
Defining Luxury Since 1959

PROPRIETARY AND CONFIDENTIAL
THE INFORMATION CONTAINED IN THIS DRAWING IS THE SOLE PROPERTY OF PHYLIRICH. ANY REPRODUCTION IN PART OR AS A WHOLE WITHOUT THE WRITTEN PERMISSION OF PHYLIRICH IS PROHIBITED.

-	-	INTERPRET GEOMETRIC DIMENSIONING & TOLERANCING IN ACCORDANCE WITH ASME Y14.5-2009 & ASME Y14.41-2003 STANDARDS, UNLESS OTHERWISE SPECIFIED. DIMENSIONS ARE IN INCHES. TOLERANCES ARE:		
NEXT ASSY	USED ON	FRACTIONS ±1/16"	DECIMALS X.X: ±.1 X.XX: ±.01 X.XXX: ±.005	ANGULAR ±2°
APPLICATION		MATERIAL	NAME	DATE
FINISH		DRAWN	LLO	11/2/2015
DO NOT SCALE DRAWING		CHECKED	GRE	

WALL TUB SET, MARBLE LEVER HANDLES, HENRI SERIES

SIZE **A** ASM/PRT NO. **161-58/00** REV **B**

SCALE: 1:3 WEIGHT: lbs. SHEET 1 OF 2

5

4

3

2

1