

NOTE(S):
 1. APPLY NSF COMPLIANT GREASE TO ANY O-RING, SEALING JOINTS, AND/OR PIVOTAL POINTS.

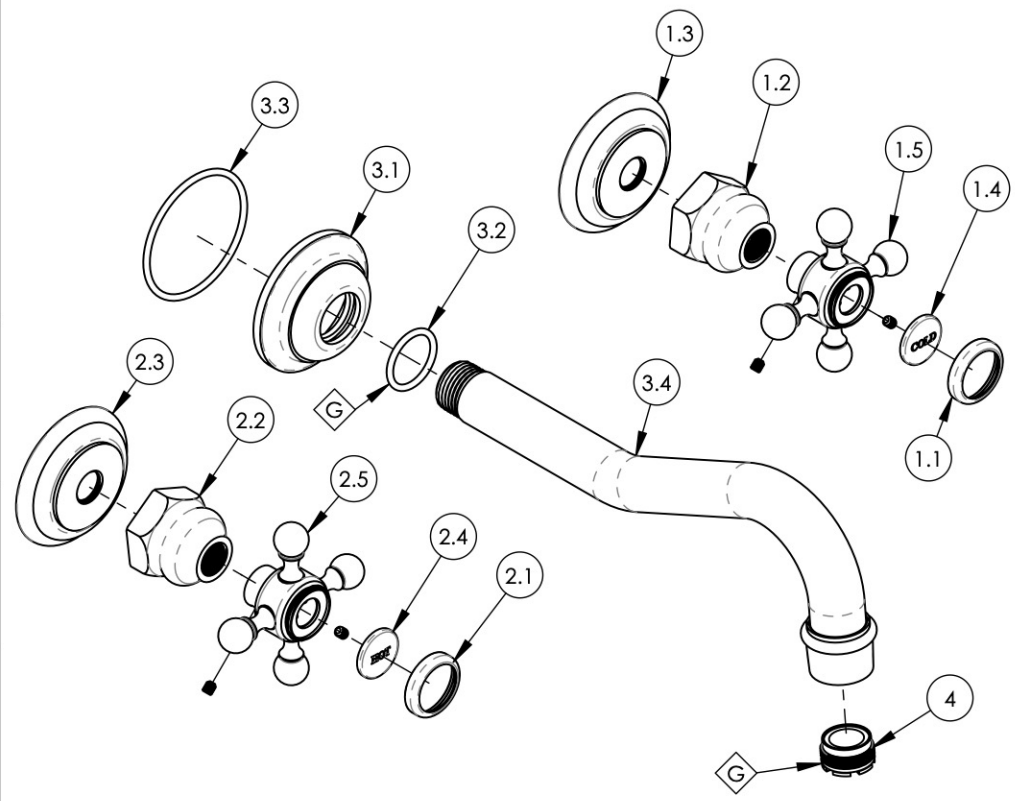

ITEM NO.	PART NUMBER	DESCRIPTION	QTY.
1	3-142C/00	CROSS HANDLE, WALL/SHOWER, 500 SERIES	1
1.1	10538/00	CAP RING FOR 500 SERIES BUTTON	1
1.2	10621/00	BASE HUB NUT	1
1.3	10618/00	ESCUTCHEON, TRADITIONAL 500	1
1.4	11098	PLASTIC BUTTON, COLD	1
1.5	2-180/00	SUB ASSY. CROSS HANDLE HUB	1
2	3-142H/00	CROSS HANDLE, WALL/SHOWER, 500 SERIES	1
2.1	10538/00	CAP RING FOR 500 SERIES BUTTON	1
2.2	10621/00	BASE HUB NUT	1
2.3	10618/00	ESCUTCHEON, TRADITIONAL 500	1
2.4	11099	PLASTIC BUTTON, HOT	1
2.5	2-180/00	SUB ASSY. CROSS HANDLE HUB	1
3	3-390/00	WALL SPOUT, HENRI SERIES	1
3.1	11158/00	FLANGE, WALL TUB	1
3.2	90118	O-RING, 7/8"ID X 1-1/16"OD X 3/32"THK., AS-568-118	1
3.3	90137	O-RING, 2-1/16"ID X 3/32"THK., AS-568-137	1
3.4	2-108/00	SUB. ASSY, WALL SPOUT	1
4	P05024	AERATOR CACHE COIN SLOT, M21.5X1.0 FULL FLOW	1

ALL	B	UPDATE TEMPLATE, HANDLE SET SCREW ORIENTATION, ADD CALL OUTS	4/23/2020	AMM
ZONE	REV.	DESCRIPTION	DATE	APPROVED
REVISIONS				

1261 LOGAN AVENUE
 COSTA MESA, CALIFORNIA 92626
 PHONE: 714.361.4800
 FAX: 714.617.3120

PHYLIRICH[®]
 Defining Luxury Since 1959

PROPRIETARY AND CONFIDENTIAL
 THE INFORMATION CONTAINED IN THIS DRAWING IS THE SOLE PROPERTY OF PHYLIRICH. ANY REPRODUCTION IN PART OR AS A WHOLE WITHOUT THE WRITTEN PERMISSION OF PHYLIRICH IS PROHIBITED.

-	-	INTERPRET GEOMETRIC DIMENSIONING & TOLERANCING IN ACCORDANCE WITH ASME Y14.5-2009 & ASME Y14.41-2003 STANDARDS, UNLESS OTHERWISE SPECIFIED. DIMENSIONS ARE IN INCHES. TOLERANCES ARE:		
NEXT ASSY	USED ON	FRACTIONS ±1/16"	DECIMALS X.X: ±.1 X.XX: ±.01 X.XXX: ±.005	ANGULAR ±2°
APPLICATION		MATERIAL	NAME	DATE
FINISH		DRAWN	LLO	11/2/2015
DO NOT SCALE DRAWING		CHECKED	GRE	

WALL TUB SET, CROSS HANDLES, HENRI SERIES

SIZE	ASM/PRT NO.	REV
A	161-56/00	B
SCALE: 1:3	WEIGHT: lbs.	SHEET 1 OF 2