

- NOTE(S):  
 1. PART NUMBER, "/00" DENOTES PART SHALL HAVE FINISH.  
 2. APPLY NSF COMPLIANT GREASE TO ANY O-RING, SEALING JOINTS, AND/OR PIVOTAL POINTS. **G**  
 3. APPLY NSF COMPLIANT LOCTITE TO THREADED AREA. **L**

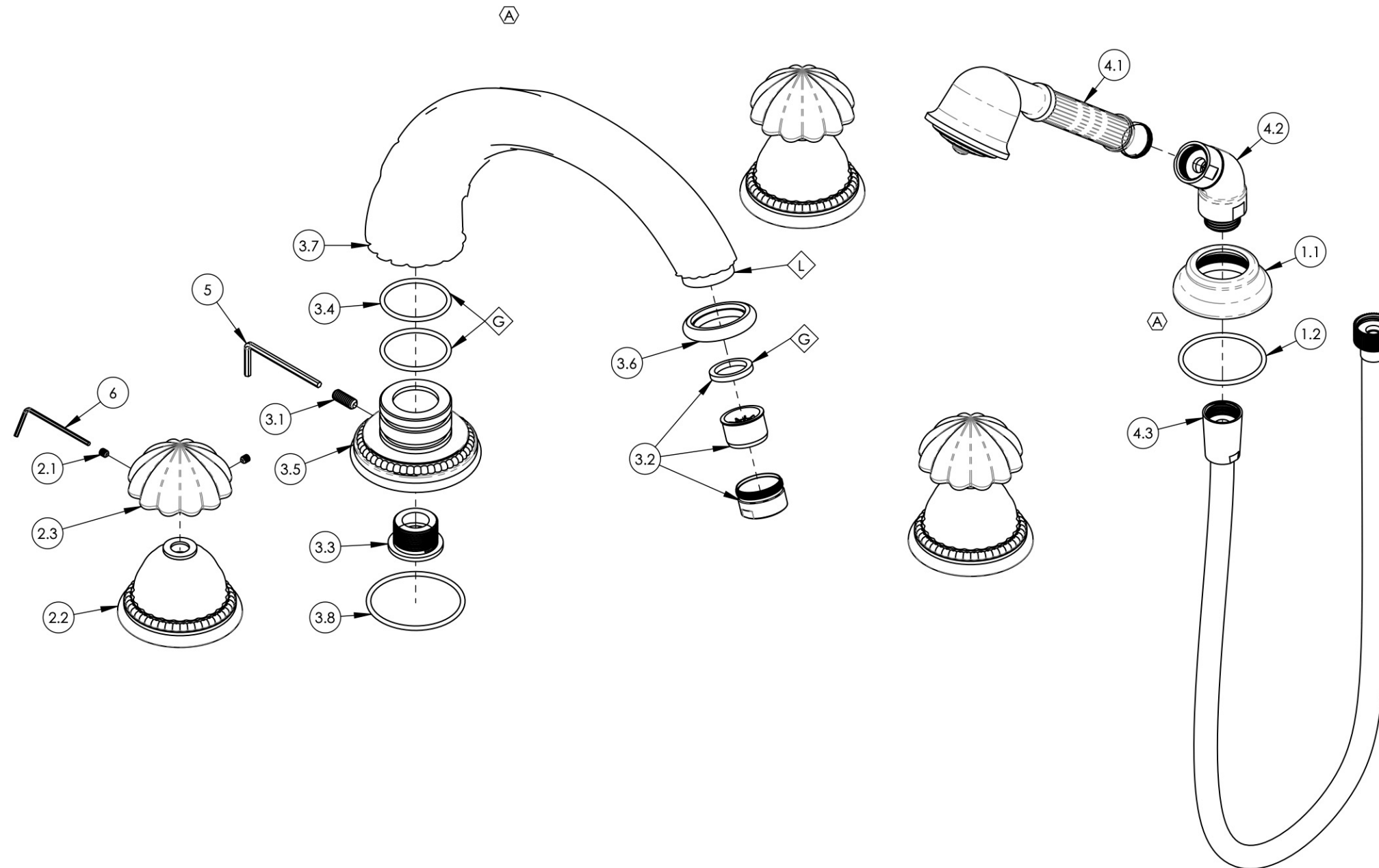

ITEM NO.	PART NUMBER	DESCRIPTION	QTY.
1	3-210/00	ESCUTCHEON BASE, HANDSHOWER, TRADITIONAL	1
1.1	P18001/00	ESCUTCHEON BASE, DECK TUB, HANDSHOWER, TRADITIONAL	1
1.2	90133	1 13/16" O-RING, 1-13/16ID X 3/32THK, AS-568-133	1
2	3-226/00	ROUND HANDLE, GEORGIAN & BARCELONA	3
2.1	92008	SET SCREW, CUP POINT 8-32, 3/16" L.	2
2.2	P02013/00	K141 COVER PLATE	1
2.3	P01015/00	K110 HANDLE	1
3	3-228/00	DECK TUB SPOUT, P27012 RIBBED, GEORGIAN & BARCELONA SERIES	1
3.1	92262	SET SCREW, CUP PT 1/4"-20 X 5/8"L	1
3.2	3-610/00	AERATOR & HOUSING, M28X1, TUB FILLER, FULL FLOW	1
3.3	P27012_5	K5141 DECK SPOUT BASE CONNECTOR	1
3.4	90127	O-RING, 1-7/16"ID X 1-5/8"OD X 3/32"THK, AS-568-127	2
3.5	10500/00	K5141 DECK SPOUT BASE	1
3.6	P27014/00	AERATOR RING	1
3.7	P27012_1/00	K5141 DECK SPOUT	1
3.8	90137	O-RING, 2-1/16"ID X 3/32"THK., AS-568-137	1
4	4-017/00	HAND SHOWER HEAD, HOSE, ELBOW, GEORGIAN	1
4.1	3-396/00	HAND SHOWER, HEAD ONLY, GEORGIAN	1
4.2	3-050/00	ELBOW ASSEMBLY	1
4.3	3-049/00	ASSY, HOSE KIT, HANDSHOWER	1
5	92216	HEX L-KEY 1/8" HEX X 2-5/16"L	1
6	P39001	5/64 HEX KEY	1

ALL	A	UPDATE SPOUT & HS ESCUTCHEON ASSY, REPLACE TEMPLATE	2/19/2020	AMM
ZONE	REV.	DESCRIPTION	DATE	APPROVED
REVISIONS				
1261 LOGAN AVENUE COSTA MESA, CALIFORNIA 92626 PHONE: 714.361.4800 FAX: 714.617.3120		<b>PHYLIRICH</b> Defining Luxury Since 1959		
<b>PROPRIETARY AND CONFIDENTIAL</b>				
THE INFORMATION CONTAINED IN THIS DRAWING IS THE SOLE PROPERTY OF PHYLIRICH. ANY REPRODUCTION IN PART OR AS A WHOLE WITHOUT THE WRITTEN PERMISSION OF PHYLIRICH IS PROHIBITED.				

NEXT ASSY	USED ON	FRACTIONS ±1/16"	DECIMALS X.X: ±.1 X.XX: ±.01 X.XXX: ±.005	ANGULAR ±2°
APPLICATION		MATERIAL	NAME	DATE
FINISH		DRAWN	AMM	8/20/2019
DO NOT SCALE DRAWING		CHECKED		

<b>DECK TUB SET W/ HANDSHOWER, ROUND HANDLES, GEORGIAN &amp; BARCELONA SERIES</b>		
SIZE	ASM/PRT NO.	REV
<b>B</b>	<b>K2361P1/00</b>	<b>A</b>
SCALE: 1:3	WEIGHT: lbs.	SHEET 1 OF 2