

NOTE(S):  
 1. PART NUMBER, "/00" DENOTES PART SHALL HAVE FINISH.

2. APPLY NSF COMPLIANT GREASE TO ANY O-RING, SEALING JOINTS, AND/OR PIVOTAL POINTS.

3. APPLY NSF COMPLIANT LOCTITE TO THREADED AREA.

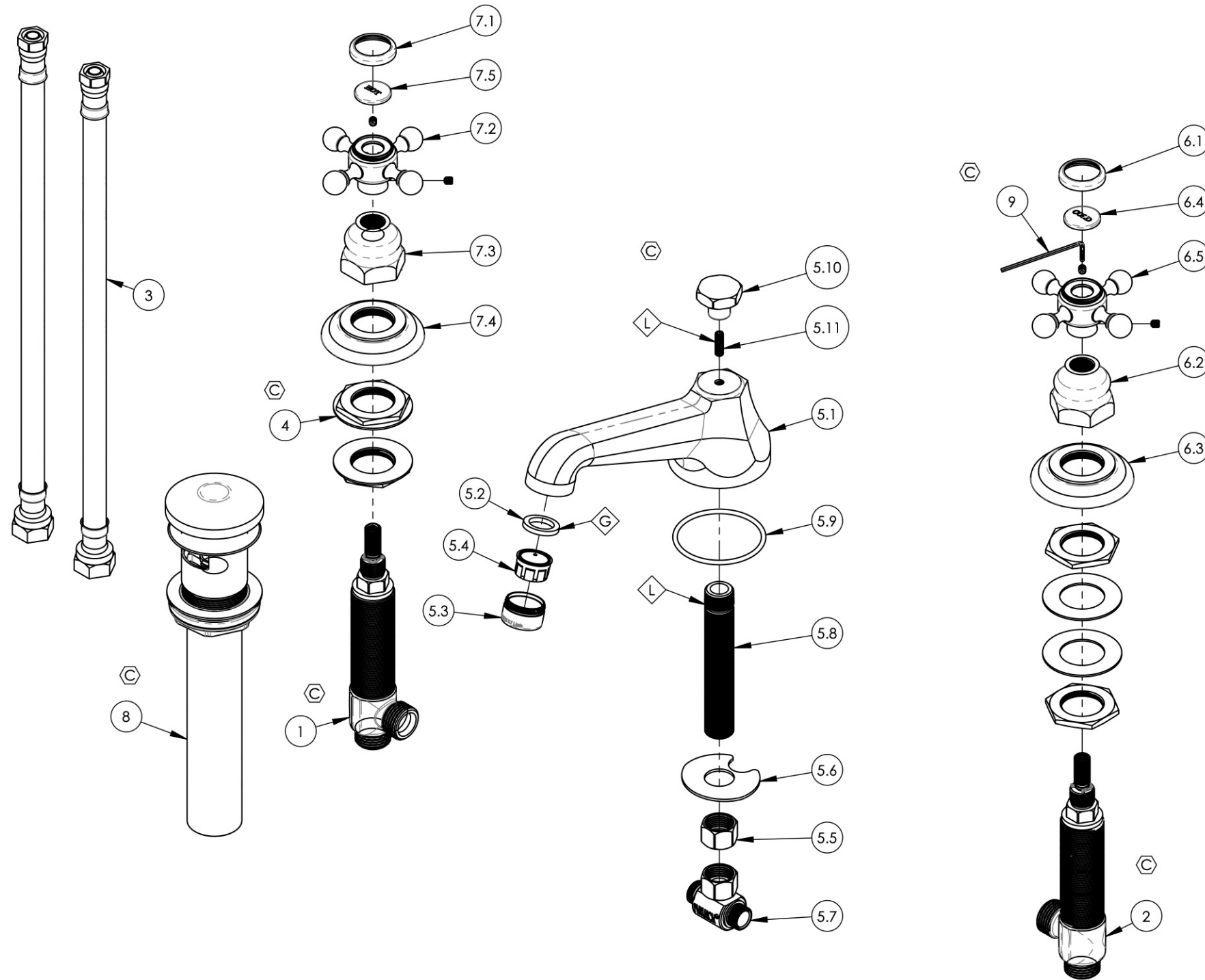

ITEM NO.	PART NUMBER	DESCRIPTION	QTY.
1	1-149	WIDESPREAD VALVE LAV 16PT, HOT, ONLY	1
2	1-150	WIDESPREAD VALVE LAV 16PT, COLD, ONLY	1
3	10982	HOSE, 3/8" COMP. X 1/2" NPSM - 12"L	2
4	2-203	MOUNTING NUT KIT, WIDESPREAD LAV	4
5	3-134/00	SPOUT ONLY WIDESPREAD LAV, HEX MOD./TRAD.	1
5.1	10919	SPOUT LOW LAV, HEX MODERN	1
5.2	30030	RUBBER SEAL WASHER AERATOR, NEOPERL PRT # BW.7110.1	1
5.3	30032/00	AERATOR HOUSING 15/16" MALE HOUSING	1
5.4	11426	AERATOR DROP-IN INSERT 1.2 GPM, NEOPERL # 40.2060.00000	1
5.5	10746	NUT, 3/8"-18 NPSL	1
5.6	92174	WASHER MOUNT WIDESPREAD (3/8")	1
5.7	1-112	TEE VALVE, 3/8" NPSM X 3/8" COMPRESSION	1
5.8	10745	THREAD ALL, 3/8"-18 NPSL - 3/8"NPT	1
5.9	90135	O-RING, 1-15/16"ID X 3/32"THK, AS-568-135	1
5.10	10920/00	POP-UP KNOB, HEX TRADITIONAL	1
5.11	92152	SET SCREW, CUP PT. 10-24 UNC X 5/8"L	1
6	3-141C/00	CROSS HANDLE, HEX TRADITIONAL, 500 SERIES	1
6.1	10538/00	CAP RING FOR 500 SERIES BUTTON	1
6.2	10621/00	BASE HUB NUT	1
6.3	10619/00	ESCUTCHEON, TRADITIONAL LAV 1"-20	1
6.4	11098	PLASTIC BUTTON, COLD	1
6.5	2-180/00	SUB ASSY. CROSS HANDLE HUB	1
7	3-141H/00	CROSS HANDLE, HEX TRADITIONAL, 500 SERIES	1
7.1	10538/00	CAP RING FOR 500 SERIES BUTTON	1
7.2	2-180/00	SUB ASSY. CROSS HANDLE HUB	1
7.3	10621/00	BASE HUB NUT	1
7.4	10619/00	ESCUTCHEON, TRADITIONAL LAV 1"-20	1
7.5	11099	PLASTIC BUTTON, HOT	1
8	3-545/00	BRASS PUSH TYPE DRAIN, W/ OVERFLOW & SMALL PLUG	1
9	P39001	HEX KEY 5/64, FOR 8-32 SET SCREW	1

ALL	C	UPDATE TEMPLATE, DWG NAME, VALVES/MOUNTING NUTS, SPOUT ASSY & DRAIN, ADD HEX KEY	5/27/2020	AMM
ZONE	REV.	DESCRIPTION	DATE	APPROVED
REVISIONS				
		1261 LOGAN AVENUE COSTA MESA, CALIFORNIA 92626 PHONE: 714.361.4800 FAX: 714.617.3120	<b>PHYLIRICH</b> Defining Luxury Since 1959	
		<b>PROPRIETARY AND CONFIDENTIAL</b> THE INFORMATION CONTAINED IN THIS DRAWING IS THE SOLE PROPERTY OF PHYLIRICH. ANY REPRODUCTION IN PART OR AS A WHOLE WITHOUT THE WRITTEN PERMISSION OF PHYLIRICH IS PROHIBITED.		

INTERPRET GEOMETRIC DIMENSIONING & TOLERANCING IN ACCORDANCE WITH ASME Y14.5-2009 & ASME Y14.41-2003 STANDARDS. UNLESS OTHERWISE SPECIFIED, DIMENSIONS ARE IN INCHES. TOLERANCES ARE:	<b>FRACTIONS</b> ±1/16"	<b>DECIMALS</b> X.X: ±.1 X.XX: ±.01 X.XXX: ±.005	<b>ANGULAR</b> ±2°
NEXT ASSY	USED ON	APPLICATION	
MATERIAL	FINISH	DRAWN	DATE
DO NOT SCALE DRAWING	CHECKED	GRE	1/27/2014

<b>WIDESPREAD LAV, LOW SPOUT W/ CROSS, HEX TRADITIONAL</b>		
SIZE	ASM/PRT NO.	REV
<b>B</b>	500-01/00	<b>C</b>
SCALE: 1:3	WEIGHT: lbs.	SHEET 1 OF 2