

NOTE(S):

PART NUMBER, "/00" DENOTES PART SHALL HAVE FINISH.

1. EXAMPLE OF SPLIT FINISH CODE:

A. 3-402/026X030

2. AVAILABLE HANDLE STONE OPTIONS:

A. BLACK MARBLE = 11328 (.../00X030)

B. WHITE MARBLE = 11329 (.../00X031)

C. SOAPSTONE = 11330 (.../00X032)

3. APPLY NSF COMPLIANT GREASE TO ANY O-RING, SEALING JOINTS, AND/OR PIVOTAL POINTS.

4. APPLY NSF COMPLIANT LOCTITE TO THREADED AREA.

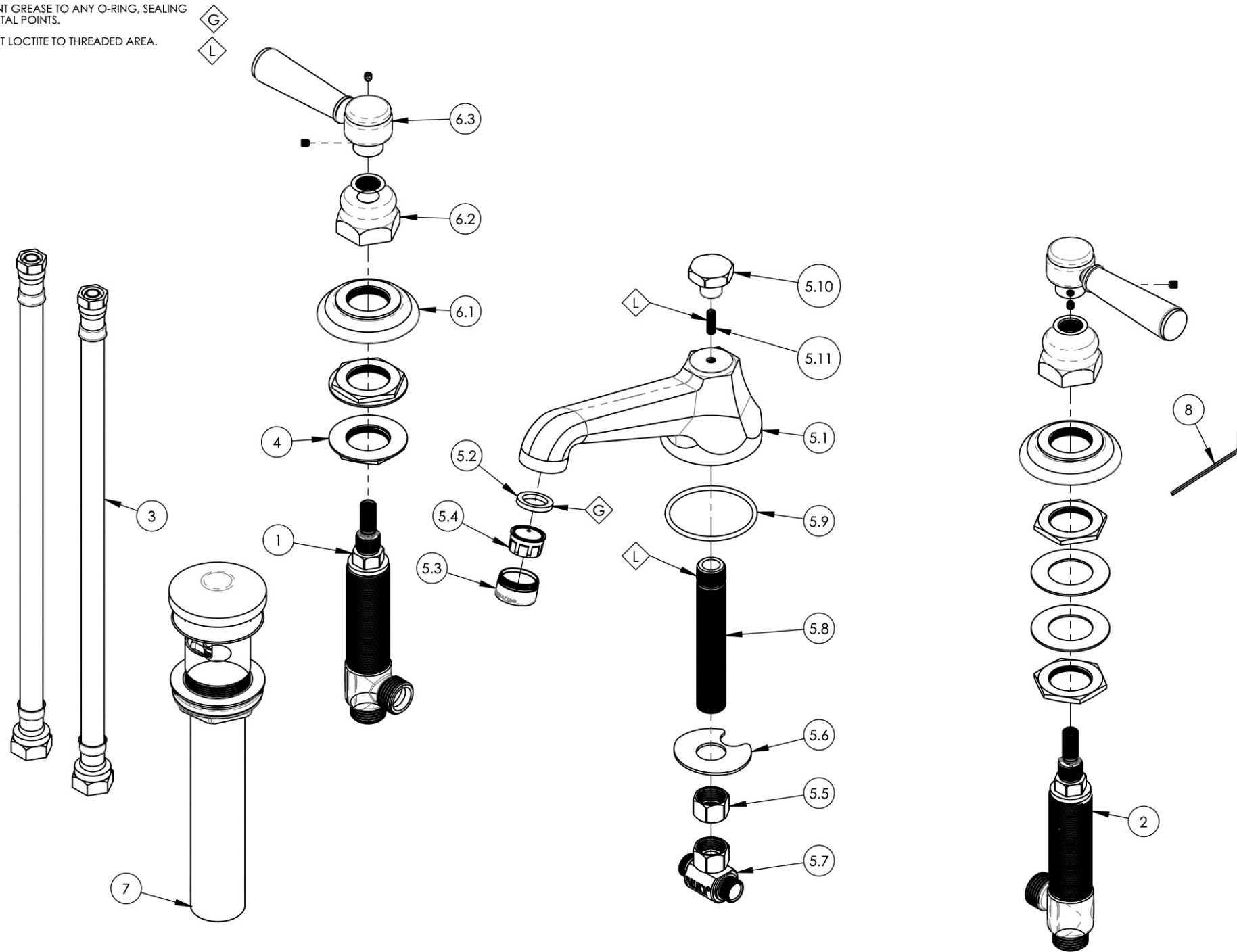

SEE NOTES*

ITEM NO.	PART NUMBER	DESCRIPTION	QTY.
1	1-149	WIDESPREAD VALVE LAV 16PT, HOT, ONLY	1
2	1-150	WIDESPREAD VALVE LAV 16PT, COLD, ONLY	1
3	10982	HOSE, 3/8" COMP. X 1/2" NPSM - 12'L	2
4	2-203	MOUNTING NUT KIT, WIDESPREAD LAV	4
5	3-134/00	SPOUT ONLY WIDESPREAD LAV, HEX MOD./TRAD.	1
5.1	10919	SPOUT LOW LAV, HEX MODERN	1
5.2	30030	RUBBER SEAL WASHER AERATOR, NEOPERL PRT # BW.7110.1	1
5.3	30032/00	AERATOR HOUSING 15/16" MALE HOUSING	1
5.4	11426	AERATOR DROP-IN INSERT 1.2 GPM, NEOPERL # 40.2060.00000	1
5.5	10746	NUT, 3/8"-18 NPSL	1
5.6	92174	WASHER MOUNT WIDESPREAD (3/8")	1
5.7	1-112	TEE VALVE, 3/8" NPSM X 3/8" COMPRESSION	1
5.8	10745	THREAD ALL, 3/8"-18 NPSL - 3/8"NPT	1
5.9	90135	O-RING, 1-15/16"ID X 3/32"THK, AS-568-135	1
5.10	10920/00	POP-UP KNOB, HEX TRADITIONAL	1
5.11	92152	SET SCREW, CUP PT. 10-24 UNC X 5/8"L	1
6	3-429/00	MARBLE LEVER HANDLE, HEX TRADITIONAL	2
6.1	10619/00	ESCUTCHEON, TRADITIONAL LAV 1"-20	1
6.2	10621/00	BASE HUB NUT	1
6.3	2-142/00	MARBLE LEVER HANDLE, 500 SERIES, HEX TRADITIONAL	1
7	3-545/00	BRASS PUSH TYPE DRAIN, W/ OVERFLOW & SMALL PLUG	1
8	P39001	HEX KEY 5/64, FOR 8-32 SET SCREW	1

ZONE	REV.	DESCRIPTION	DATE	APPROVED	
REVISIONS					
1261 LOGAN AVENUE COSTA MESA, CALIFORNIA 92626 PHONE: 714.361.4800 FAX: 714.617.3120		PHYLIRICH Defining Luxury Since 1959	PROPRIETARY AND CONFIDENTIAL THE INFORMATION CONTAINED IN THIS DRAWING IS THE SOLE PROPERTY OF PHYLIRICH. ANY REPRODUCTION IN PART OR AS A WHOLE WITHOUT THE WRITTEN PERMISSION OF PHYLIRICH IS PROHIBITED.		

-		INTERPRET GEOMETRIC DIMENSIONING & TOLERANCING IN ACCORDANCE WITH ASME Y14.5-2009 & ASME Y14.41-2003 STANDARDS. UNLESS OTHERWISE SPECIFIED, DIMENSIONS ARE IN INCHES. TOLERANCES ARE:	
NEXT ASSY	USED ON	FRACTIONS ±1/16"	DECIMALS X.X: ±.1 X.XX: ±.01 X.XXX: ±.005
APPLICATION		ANGULAR ±2°	
MATERIAL		NAME	DATE
FINISH		DRAWN	AMM 12/12/2019
DO NOT SCALE DRAWING		CHECKED	

WIDESPREAD LAV, LOW SPOUT W/ MARBLE, HEX TRADITIONAL		
SIZE	ASM/PRT NO.	REV
B	500-03/00	-
SCALE: 1:3	WEIGHT: lbs.	SHEET 1 OF 2