

- NOTE(S):
1. APPLY NSF COMPLIANT GREASE TO ANY O-RING, SEALING JOINTS, AND/OR PIVOTAL POINTS.
 2. APPLY NSF COMPLIANT LOCTITE TO THREADED AREA.

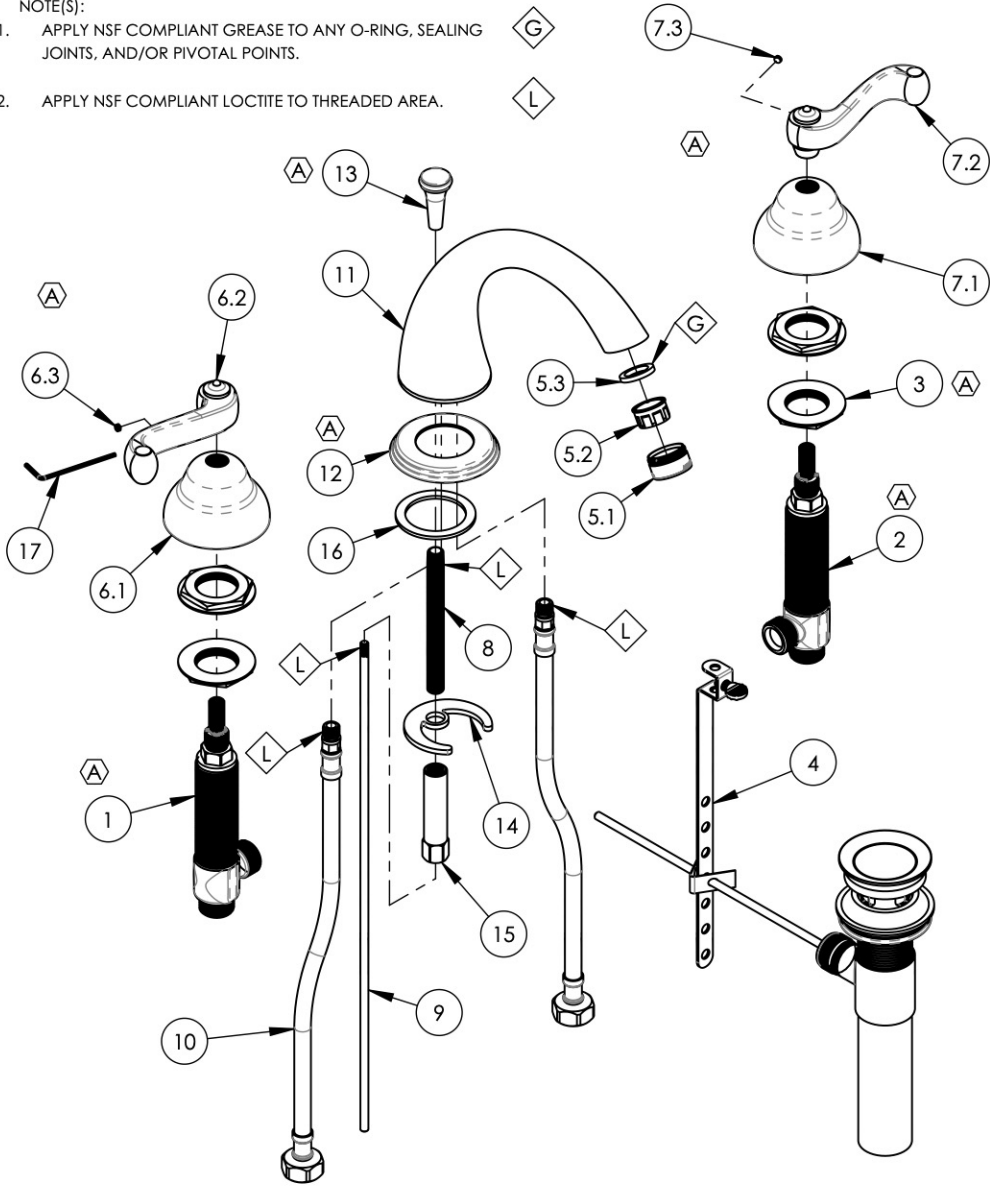

ITEM NO.	PART NUMBER	DESCRIPTION	QTY.
1	1-149	WIDESPREAD VALVE LAV 16PT, HOT, ONLY	1
2	1-150	WIDESPREAD VALVE LAV 16PT, COLD, ONLY	1
3	2-203	MOUNTING NUT KIT, WIDESPREAD LAV	4
4	3-046/00	POP-UP DRAIN ASSEMBLY (2-101, 2-102, & 2-246)	1
5	3-059/00	AERATOR, 15/16" MALE HOUSING	1
5.1	30032/00	AERATOR HOUSING 15/16" MALE HOUSING	1
5.2	11426	AERATOR DROP-IN INSERT 1.2 GPM, NEOPERL # 40.2060.00000	1
5.3	30030	RUBBER SEAL WASHER AERATOR, NEOPERL PRT # BW.7110.1	1
6	3-472/00	ASSY. LEFT CURVED HANDLE, REVERE & SAVANNAH	1
6.1	P02004/00	K190X2 COVER PLATE	1
6.2	P01001/00	HANDLE LEVER, LEFT REVERE & SAVANNAH	1
6.3	92163	SET SCREW, CONE PT 8-32 X 1/8"L	1
7	3-473/00	ASSY. RIGHT CURVED HANDLE, REVERE & SAVANNAH	1
7.1	P02004/00	K190X2 COVER PLATE	1
7.2	P01002/00	HANDLE LEVER, RIGHT REVERE & SAVANNAH	1
7.3	92163	SET SCREW, CONE PT 8-32 X 1/8"L	1
8	10182	NIPPLE, SHANK 1/8"-27NPSM X 4"L	1
9	10719/00	POP-UP ROD, 10-24, 14" LONG	1
10	10720	HOSE, M10 TO 1/2NPSM	2
11	P03024NL/00	SPOUT, SMOOTH	1
12	P03038	THREE RING SPOUT BASE F/D205/D206 LAV SPOUT	1
13	P04022	POP-UP KNOB, THREE RADIUS	1
14	P34002	C-WASHER FOR TEE LESS SPOUT	1
15	P34004	2" EXTENTION NUT F/TEE LEES SPOUT	1
16	P34005	GASKET FOR TEE LESS.	1
17	P39001	HEX KEY 5/64, FOR 8-32 SET SCREW	1

ALL	A	UPDATE TEMPLATE, VALVES, DWG NAME, SPOUT BASE, POP UP KNOB, ADD HANDLE SUBASSYS	6/18/2020	AMM
ZONE	REV.	DESCRIPTION	DATE	APPROVED
REVISIONS				

1261 LOGAN AVENUE
COSTA MESA, CALIFORNIA 92626
PHONE: 714.361.4800
FAX: 714.617.3120

PHYLIRICH[®]
Defining Luxury Since 1959

PROPRIETARY AND CONFIDENTIAL
THE INFORMATION CONTAINED IN THIS DRAWING IS THE SOLE PROPERTY OF PHYLIRICH. ANY REPRODUCTION IN PART OR AS A WHOLE WITHOUT THE WRITTEN PERMISSION OF PHYLIRICH IS PROHIBITED.

INTERPRET GEOMETRIC DIMENSIONING & TOLERANCING IN ACCORDANCE WITH ASME Y14.5-2009 ASME Y14.41-2003 STANDARDS, UNLESS OTHERWISE SPECIFIED. DIMENSIONS ARE IN INCHES. TOLERANCES ARE:			
	FRACTIONS ±1/16"	DECIMALS X.X: ±.1 X.XX: ±.01 X.XXX: ±.005	ANGULAR ±2°
NEXT ASSY	USED ON		
APPLICATION			
MATERIAL		NAME	DATE
FINISH	DRAWN	CA	10/10/2013
DO NOT SCALE DRAWING	CHECKED	GRE	

WIDESPREAD LAV, CURVED LEVER, REVERE & SAVANNAH (100-02/00)

SIZE	ASM/PRT NO.	REV
A	D202/00	A
SCALE: 1:4.5	WEIGHT: lbs.	SHEET 1 OF 2