

- NOTE(S):
- PART NUMBER, "/00" DENOTES PART SHALL HAVE FINISH.
  - APPLY NSF COMPLIANT GREASE TO ANY O-RING, SEALING JOINTS, AND/OR PIVOTAL POINTS.
  - APPLY NSF COMPLIANT LOCTITE TO THREADED AREA.
  - APPLY NSF COMPLIANT REMOVABLE (BLUE) LOCTITE TO THREADED AREA.
  - SILVER SOLDER JOINTS SHALL BE FULLY WETTED VIA CAPILLARY ACTION AND COMPLETELY NON POROUS.

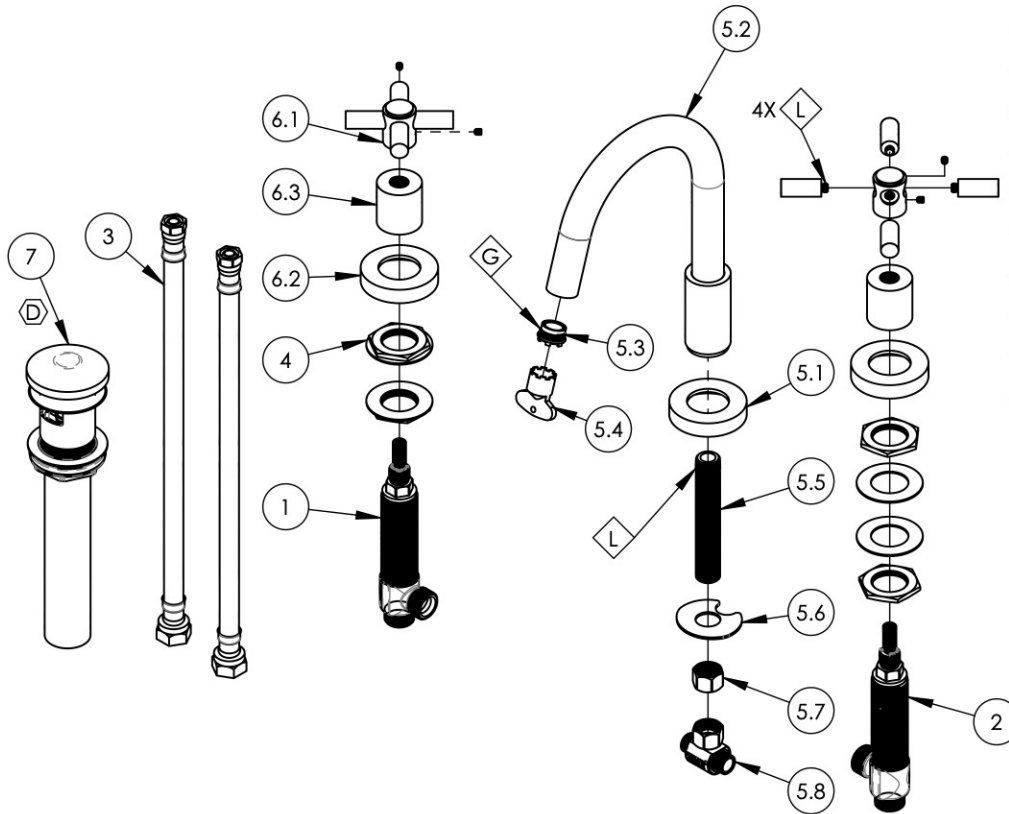

ITEM NO.	PART NUMBER	DESCRIPTION	QTY.
1	1-149	WIDESPREAD VALVE LAV 16PT, HOT, ONLY	1
2	1-150	WIDESPREAD VALVE LAV 16PT, COLD, ONLY	1
3	10982	HOSE, 3/8" COMP. X 1/2" NPSM - 12'L	2
4	2-203	MOUNTING NUT KIT, WIDESPREAD LAV	4
5	3-180/00	WIDESPREAD FAUCET GOOSENECK LOW SPOUT, BASIC	1
5.1	P02035_2/00	ESCUTCHEON, CONTEMPORARY	1
5.2	2-165/00	SUB ASSY. SPOUT LOW ARC. WIDESPREAD BASIC	1
5.3	11428	AERATOR, CACHE TJ, 1.2GPM PCA PINK, 43.2260.450	1
5.4	P05022	AERATOR, BASIC KEY, PLASTIC GREEN	1
5.5	10745	THREAD ALL, 3/8"-18 NPSL - 3/8"NPT	1
5.6	92174	WASHER MOUNT WIDESPREAD (3/8")	1
5.7	10746	NUT, 3/8"-18 NPSL	1
5.8	1-112	TEE VALVE, 3/8" NPSM X 3/8" COMPRESSION	1
6	3-442/00	ASSY, TUBULAR CROSS HANDLE, BASIC	2
6.1	3-439/00	ASSY. CROSS HANDLE TUBULAR, BASIC SERIES	1
6.2	P02035_2/00	ESCUTCHEON, CONTEMPORARY	1
6.3	P02035_1/00	HUB ESCUTCHEON, CONTEMPORARY TOP	1
7	3-545/00	BRASS PUSH TYPE DRAIN, W/ OVERFLOW & SMALL PLUG	1

ZONE	REV.	DESCRIPTION	DATE	APPROVED
C5	D	UPDATE DRAIN	11/3/2021	AMM
REVISIONS				

1261 LOGAN AVENUE  
COSTA MESA, CALIFORNIA 92626  
PHONE: 714.361.4800  
FAX: 714.617.3120

**PHYL RICH**<sup>®</sup>  
Defining Luxury Since 1959

**PROPRIETARY AND CONFIDENTIAL**  
THE INFORMATION CONTAINED IN THIS DRAWING IS THE SOLE PROPERTY OF PHYL RICH. ANY REPRODUCTION IN PART OR AS A WHOLE WITHOUT THE WRITTEN PERMISSION OF PHYL RICH IS PROHIBITED.  
**DO NOT SCALE DRAWING**

WIDESPREAD LAV SET, MID SPOUT, CROSS TUBULAR, BASIC, (131-02)

SIZE <b>A</b>	ASM/PRT NO. D135/00	REV D
SCALE: 1:5.25	WEIGHT: lbs.	SHEET 1 OF 2